

A
B
C
D
E
F
G
H

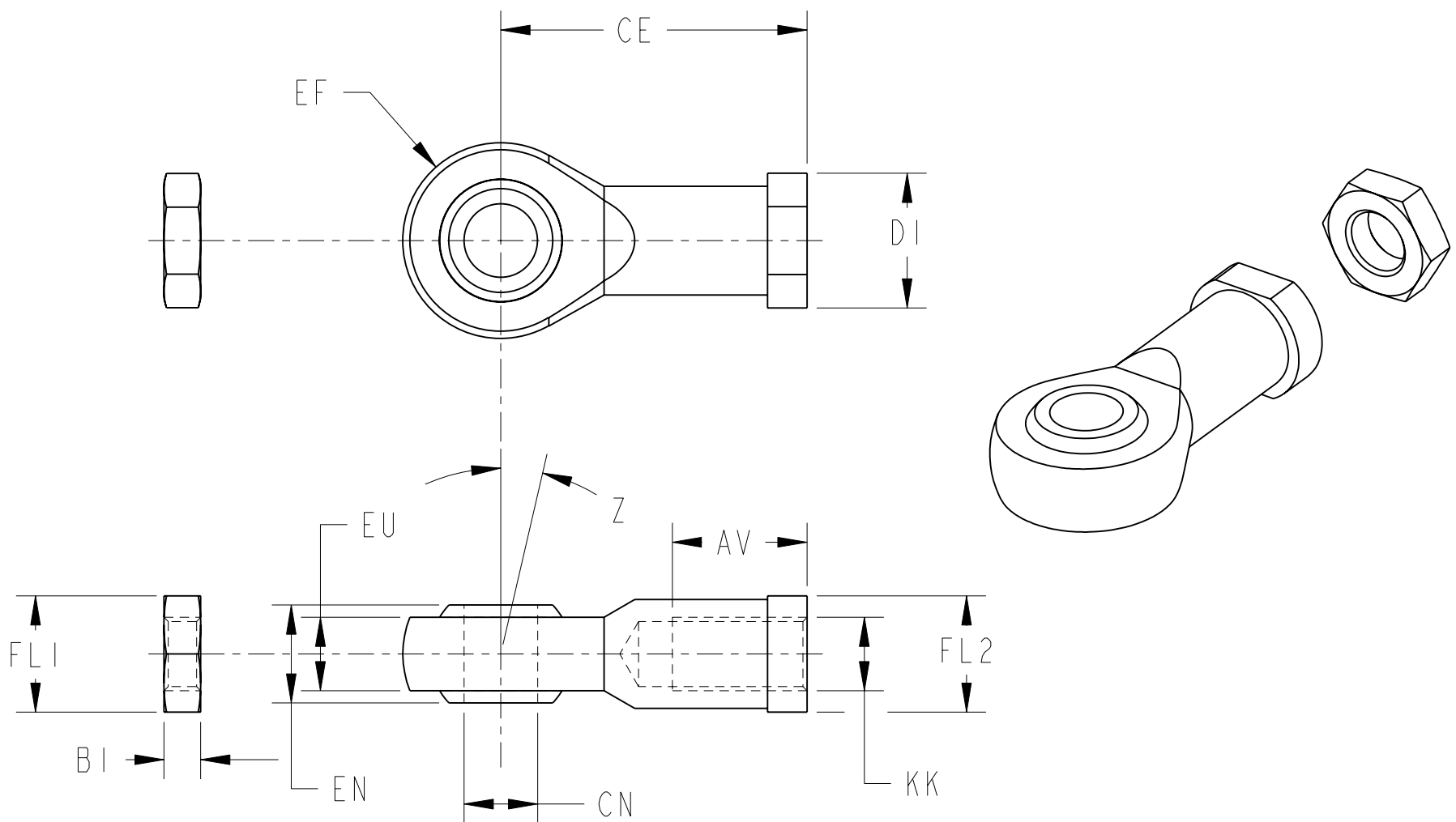

HIGH CORROSION PROTECTION
MATERIAL: HIGH-ALLOY STEEL

CATALOG NO.	MATERIAL MASTER NO.	MPAR PIN NO.	FOR SIZE [mm]
MPAR-NE195582	PN-42353	00884951094130	32
MPAR-NE195583	PN-42354	00884951094147	40
MPAR-NE195584	PN-42355	00884951094154	63

BASIC VERSION
MATERIAL: GALVANISED STEEL

CATALOG NO.	MATERIAL MASTER NO.	MPAR PIN NO.	FOR SIZE [mm]	KK	AV	BI	CE	CN ∅	DI ∅	EF ±0.5	EN	EU	Z [°]	FL1	FL2	WEIGHT [kg]
MPAR-NE9261	PN-42333	00884951094383	32	M10x1.25	20	5	43	10	19	14	14	10.5	13	17	17	0.07
MPAR-NE9262	PN-42335	00884951094390	40	M12x1.25	22	6	50	12	22	16	16	12	13	19	19	0.11
MPAR-NE9263	PN-42336	00884951094406	63	M16x1.5	28	8	64	16	27	21	21	15	15	24	22	0.21

- NOTES:
- ALL DIMENSIONS ARE IN MILLIMETERS.
 - TOLERANCES APPLY ONLY WHEN SPECIFIED.
 - DIMENSIONS ARE SAME FOR BOTH MATERIAL TYPES SHOWN
 - ASSEMBLY INCLUDES 1 RODE EYE, 1 HEX NUT TO DIN 439

PARTS MUST CONFORM TO APPLICABLE ROCKWELL AUTOMATION MANUFACTURING STANDARDS
CAD DOCUMENT
FILE NAME 10000048450

REFERENCES		MPAR, ROD-EYE, ESM		Rockwell Automation CONFIDENTIAL AND PROPRIETARY INFORMATION THIS DOCUMENT CONTAINS CONFIDENTIAL AND PROPRIETARY INFORMATION OF ROCKWELL AUTOMATION, INC. AND MAY NOT BE USED, COPIED OR DISCLOSED TO OTHERS, EXCEPT WITH THE AUTHORIZED WRITTEN PERMISSION OF ROCKWELL AUTOMATION, INC.	
REVISION AUTHORIZATION	DIMENSIONS APPLY BEFORE SURFACE TREATMENT DIMENSIONS IN MILLIMETERS TOLERANCES UNLESS OTHERWISE SPECIFIED 0 TO 6mm ±0.1 >6 TO 30mm ±0.2 >30mm ±0.3 ALL RADII ±0.2 ANGLES ±1°	DR. ADS	DATE 16-Feb-09		
		CHKD.	DATE	SHEET 1 OF 1	
00		APPD.	DATE	DWG. SIZE B	
				10000048450	