

APPROX. WEIGHT (LBS)  
63

ECO No	DESCRIPTION	REV BY	DATE

CRITICAL TO QUALITY CLASSIFICATION TABLE				
P-PERFORMANCE FIT ASSEMBLY I-IDENTIFIABLE CLASSIFICATION E-ENGINEERING MANUFACTURING REQUIREMENT R-REGULATORY REQUIREMENT/COMPLIANCE MANDATORY				
COMMENTS	DRAWING ZONE	Ⓟ	Ⓡ	Ⓢ
ROHS	G1-H1			X

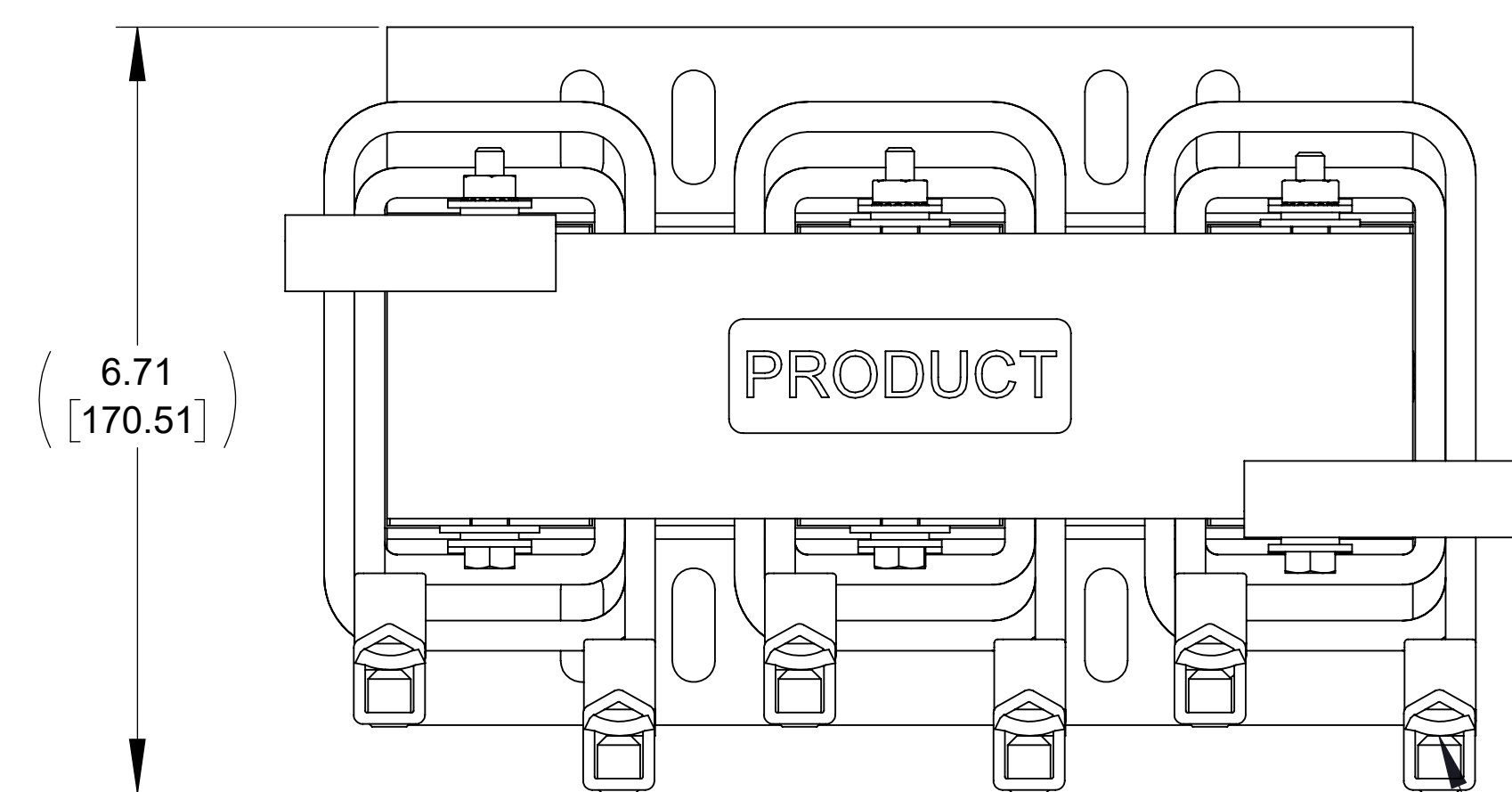

TOP VIEW

SEE NOTE 1

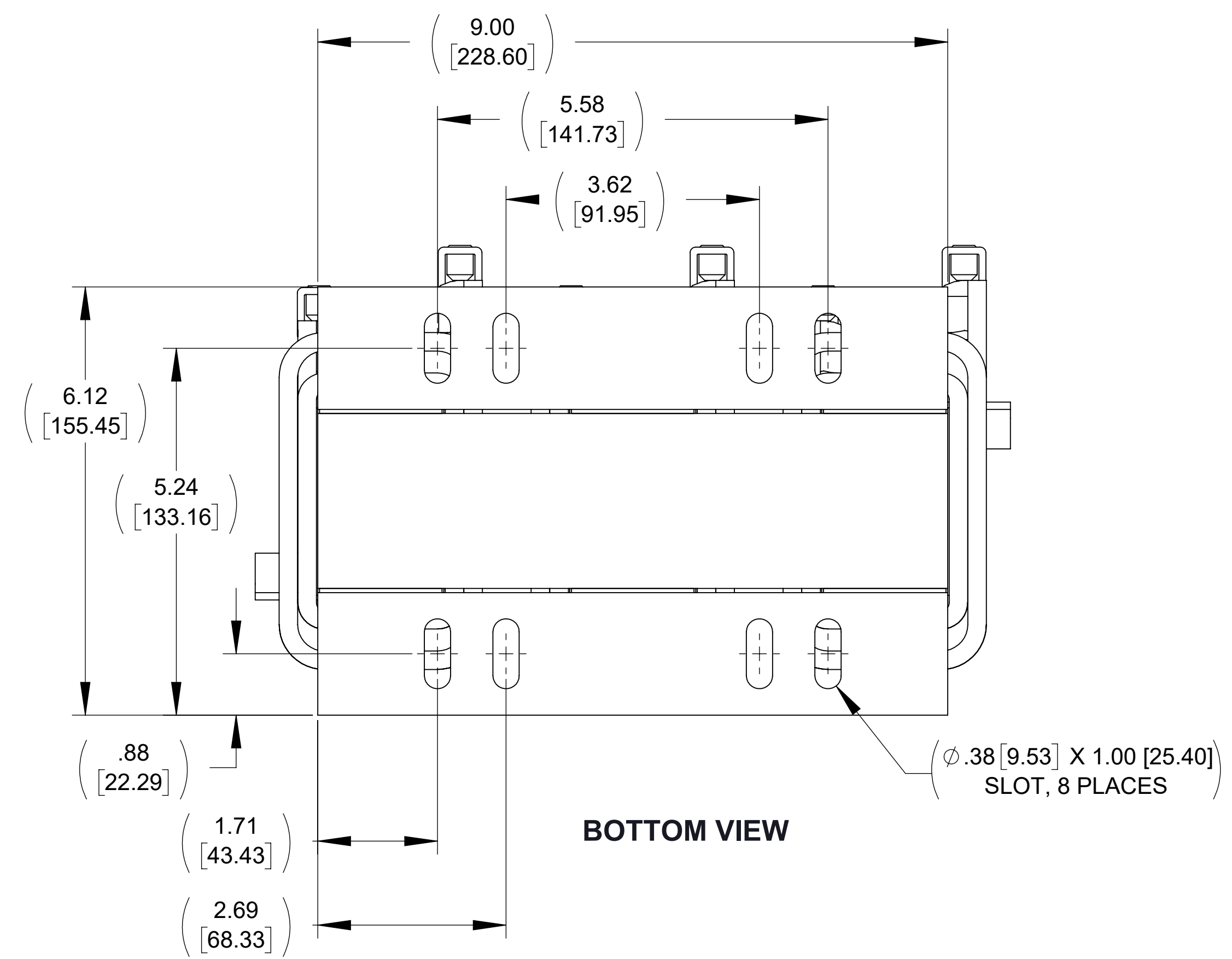

BOTTOM VIEW

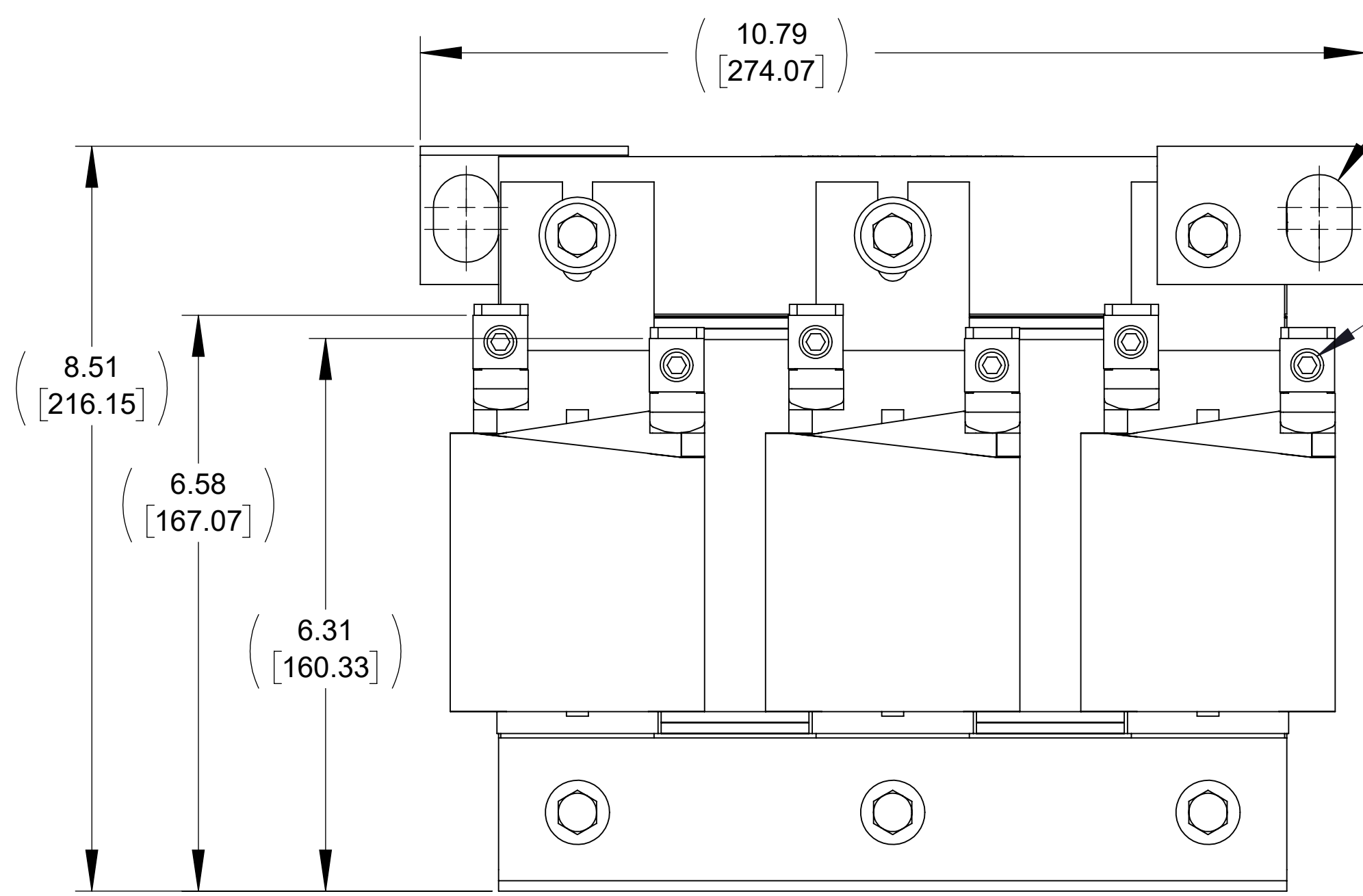
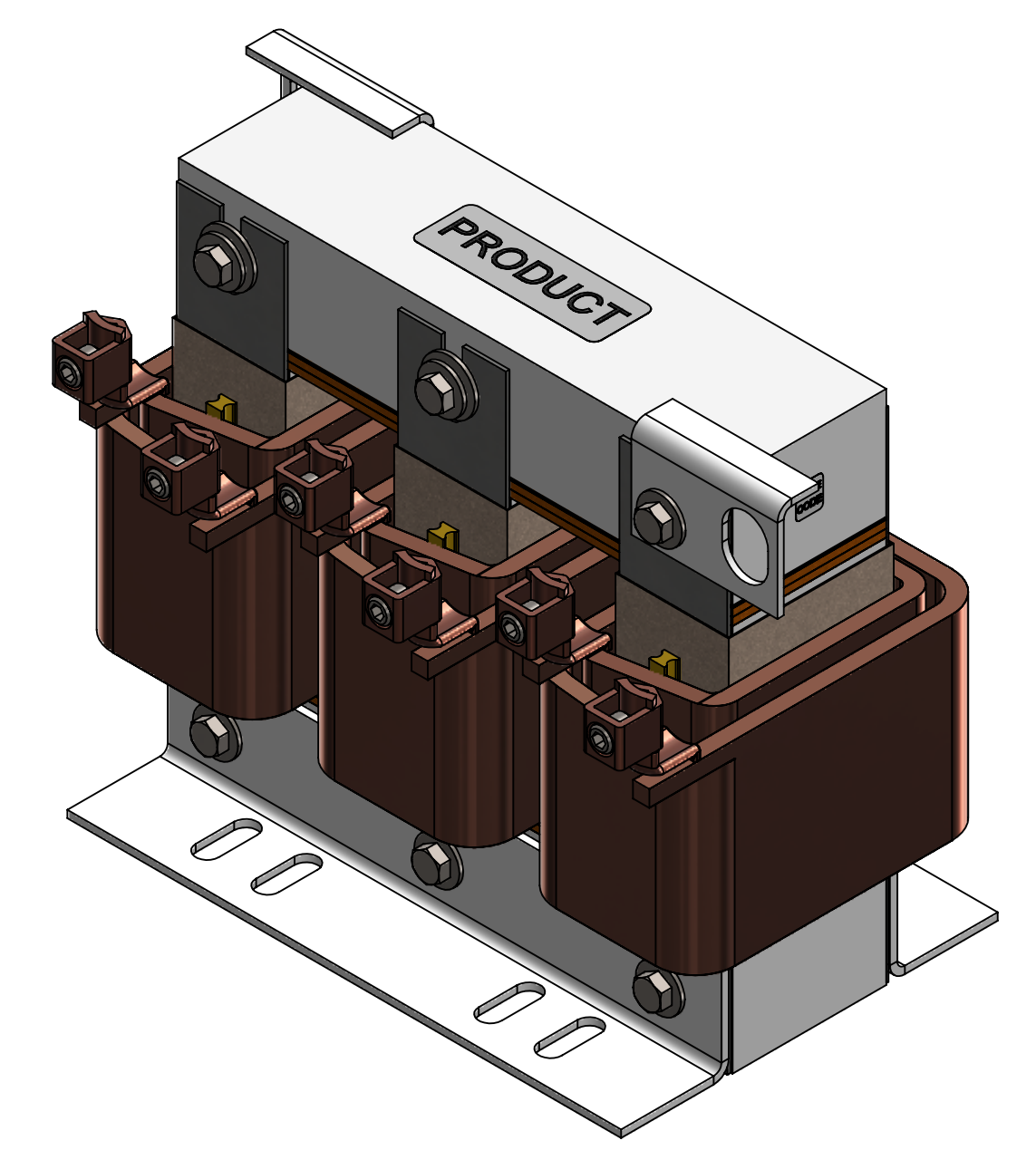

FRONT VIEW

SEE NOTE 2

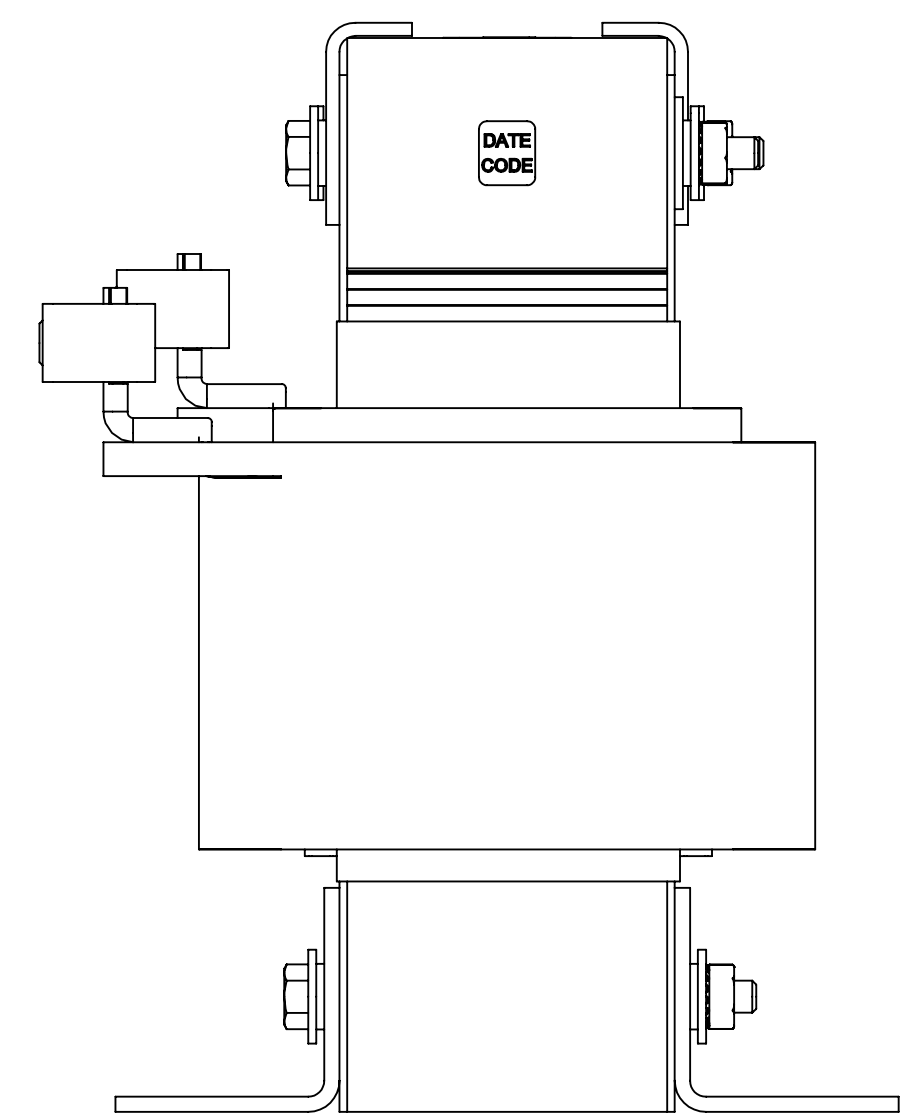

SIDE VIEW

**NOTES:**

1. TERMINAL WIRE RANGE: 6-0 AWG.
2. TERMINAL SCREW TIGHTENING TORQUE: 6-4AWG (45 IN/LBS), 2-0AWG (50 IN/LBS).
3. REFER TO USER MANUAL FOR COMPLETE INSTALLATION INSTRUCTIONS.

THE COMPONENT, PART OR ASSEMBLY DESCRIBED IN THIS DOCUMENT MUST COMPLY WITH THE EU (EUROPEAN UNION) DIRECTIVE RoHS2		MATERIAL		CONFIDENTIAL AND PROPRIETARY INFORMATION THIS DOCUMENT CONTAINS CONFIDENTIAL AND PROPRIETARY INFORMATION OF MTE CORPORATION AND MAY NOT BE USED, COPIED OR DISCLOSED TO OTHERS EXCEPT WITH THE AUTHORIZED WRITTEN PERMISSION OF MTE CORPORATION		
CONTAINS <0.1% OF ANY SVHC BY WEIGHT PER REACH REGULATION				DESCRIPTION		
UNLESS OTHERWISE SPECIFIED DIMENSIONS ARE IN INCHES [MM] TOLERANCES ARE: ANGLES: ± 1 ° 1 PLACE .X: ± .1 [2.5] 2 PLACE .XX: ± .03 [0.76] 3 PLACE .XXX: ± .010 [0.254]				LINE/LOAD REACTOR (80A 0.7 0mH)		
DRAWN WF DATE 01/22/20				SIZE D	DWG No. CD 1321-3R80-C	REV 00
CHECKED WF DATE 01/23/20				SCALE 2:3		
APPROVED PY DATE 01/24/20		SHEET 1 OF 1				