

APPROX. WEIGHT (LBS)
280

ECO No	DESCRIPTION	REV BY	DATE

CRITICAL TO QUALITY CLASSIFICATION TABLE				
<small> P-PROFORMANCE FIT/ASSEMBLY F-IDENTIFIABLE CLASSIFICATION E-ENGINEERING AND/OR MANUFACTURING REQUIREMENT R-REGULATORY REQUIREMENT/COMPLIANCE IS MANDATORY </small>				
COMMENTS	DRAWING ZONE	P	F	R
ROHS	G1-H1			X

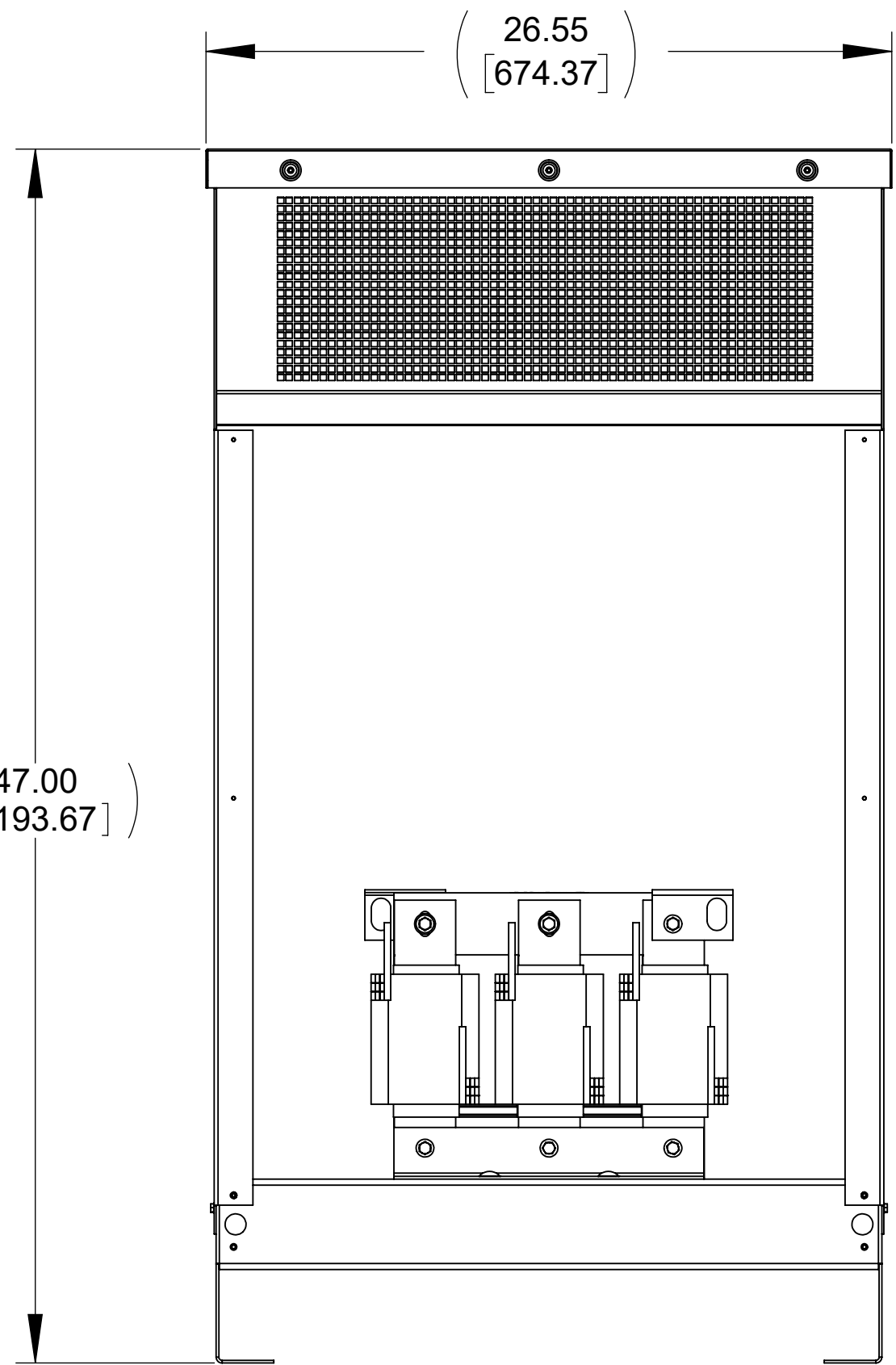

FRONT VIEW (PANEL REMOVED)

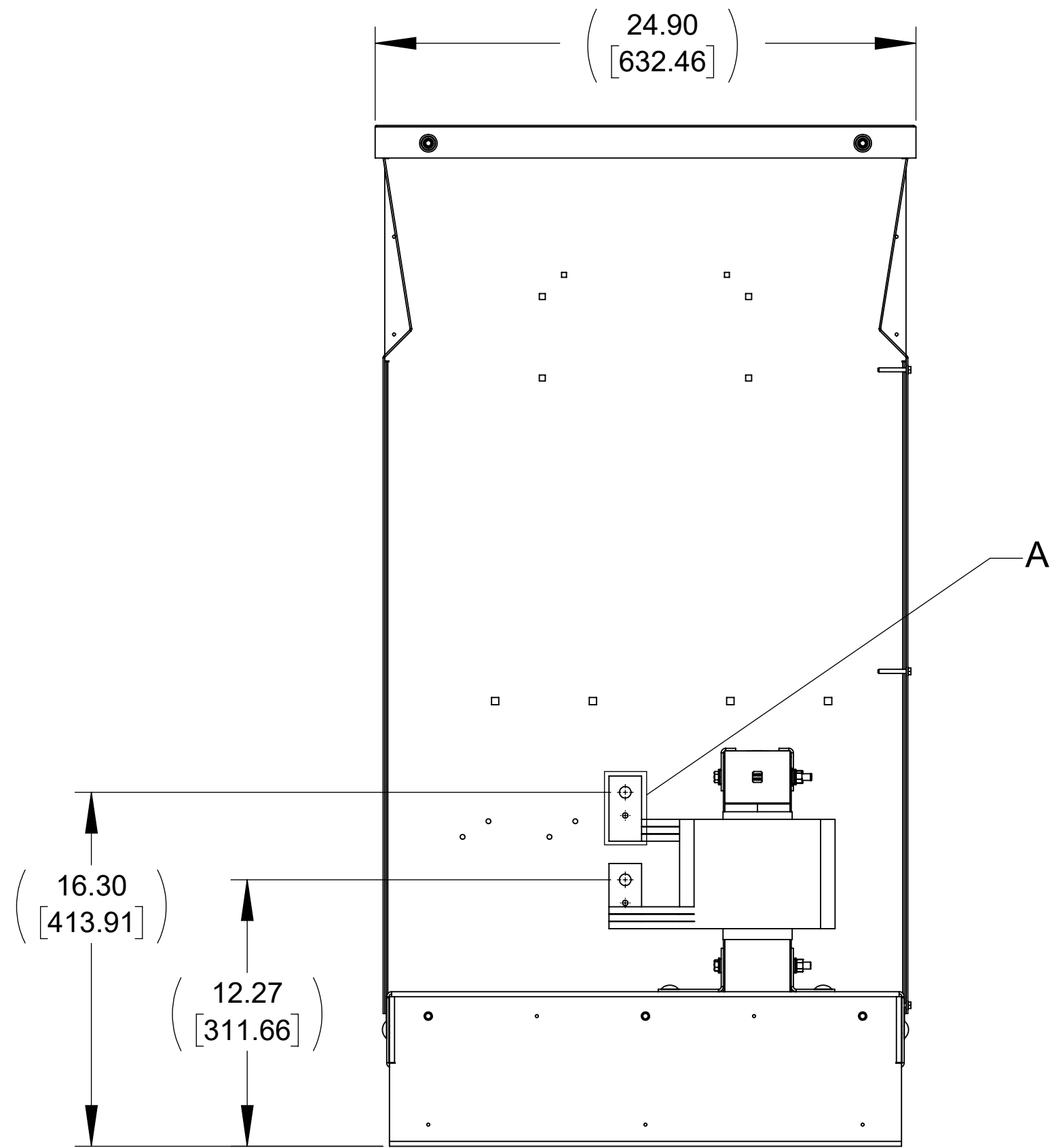

SIDE VIEW (PANEL REMOVED)

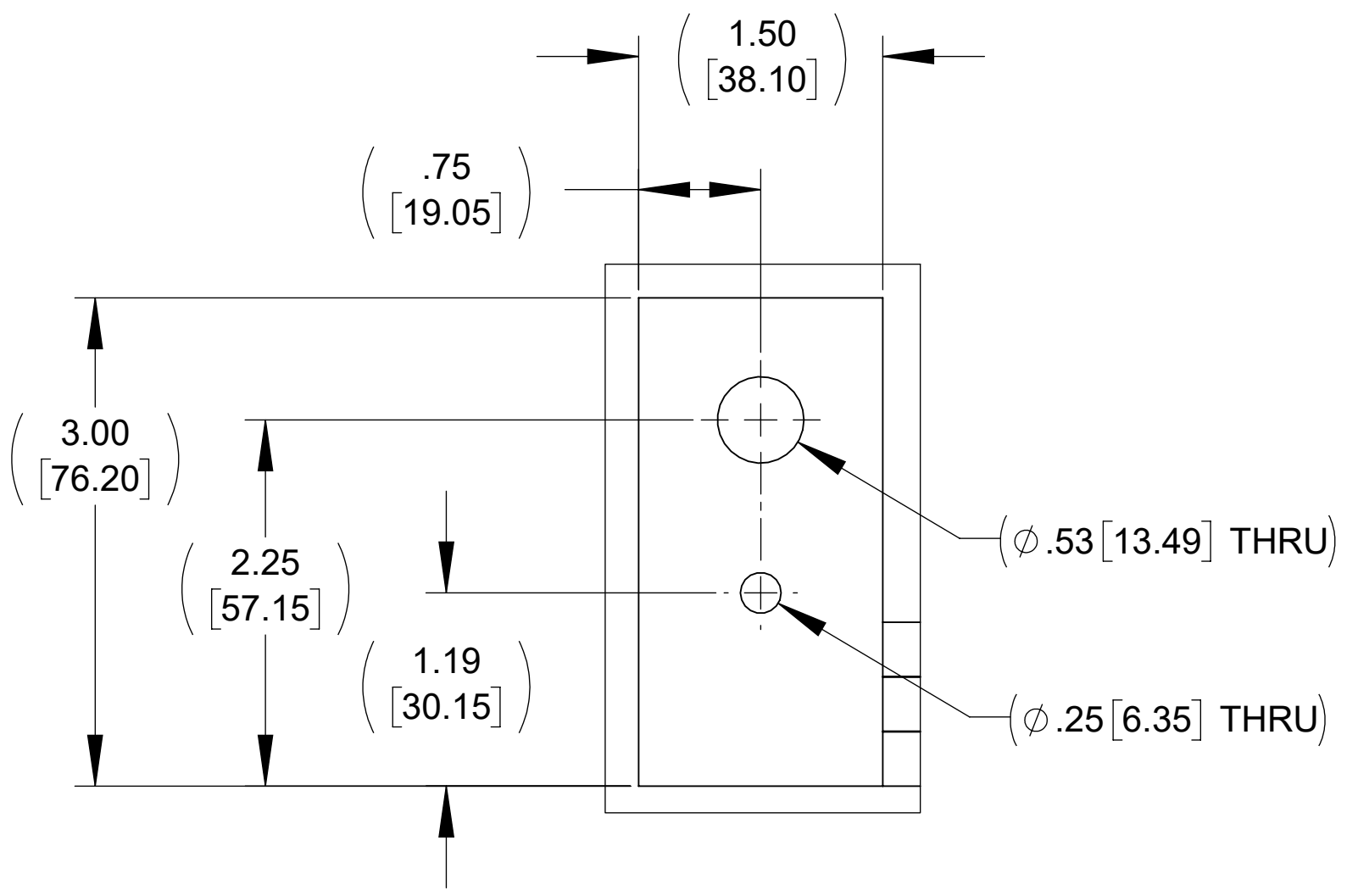
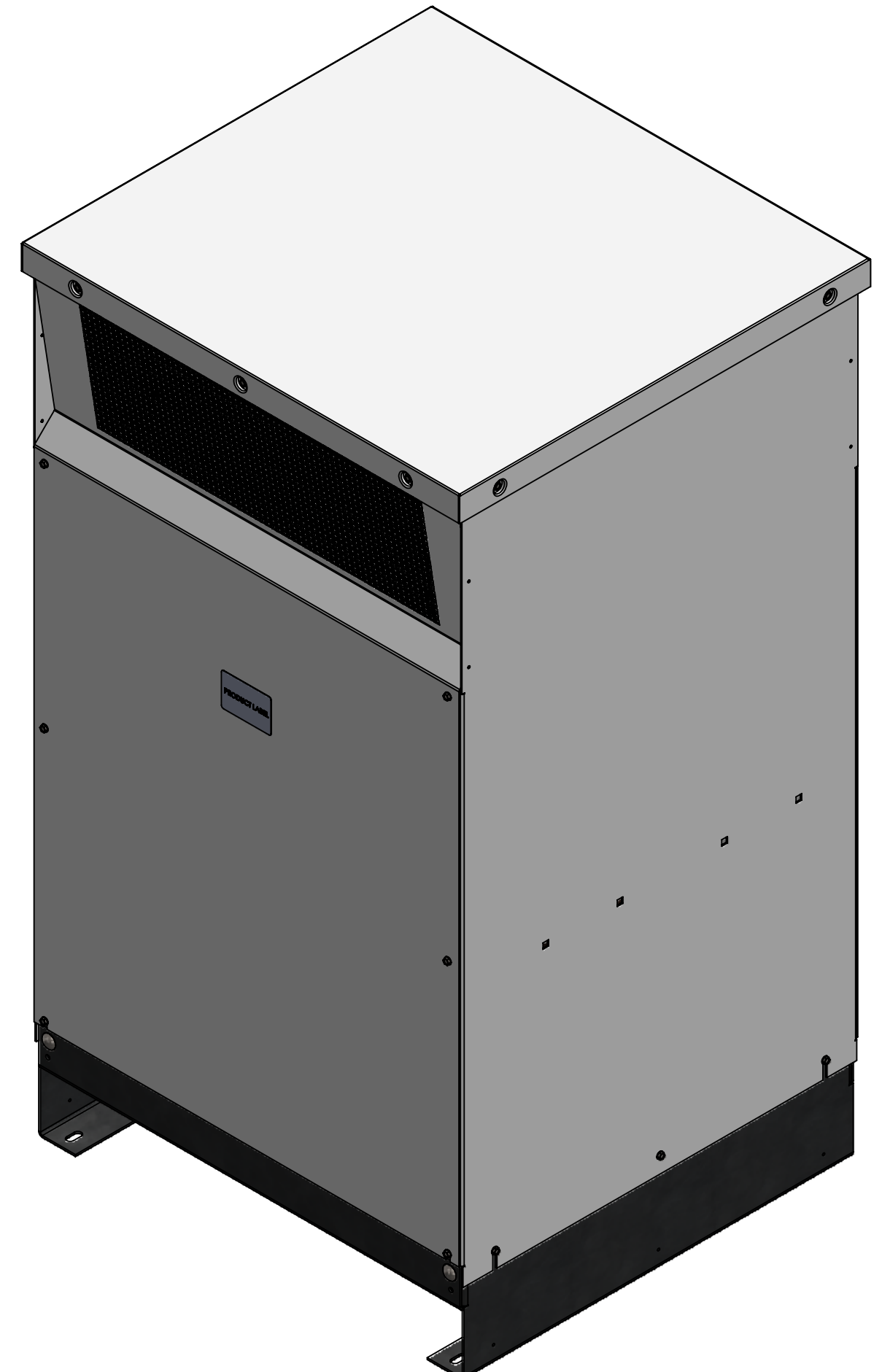

DETAIL A (6 PLACES)

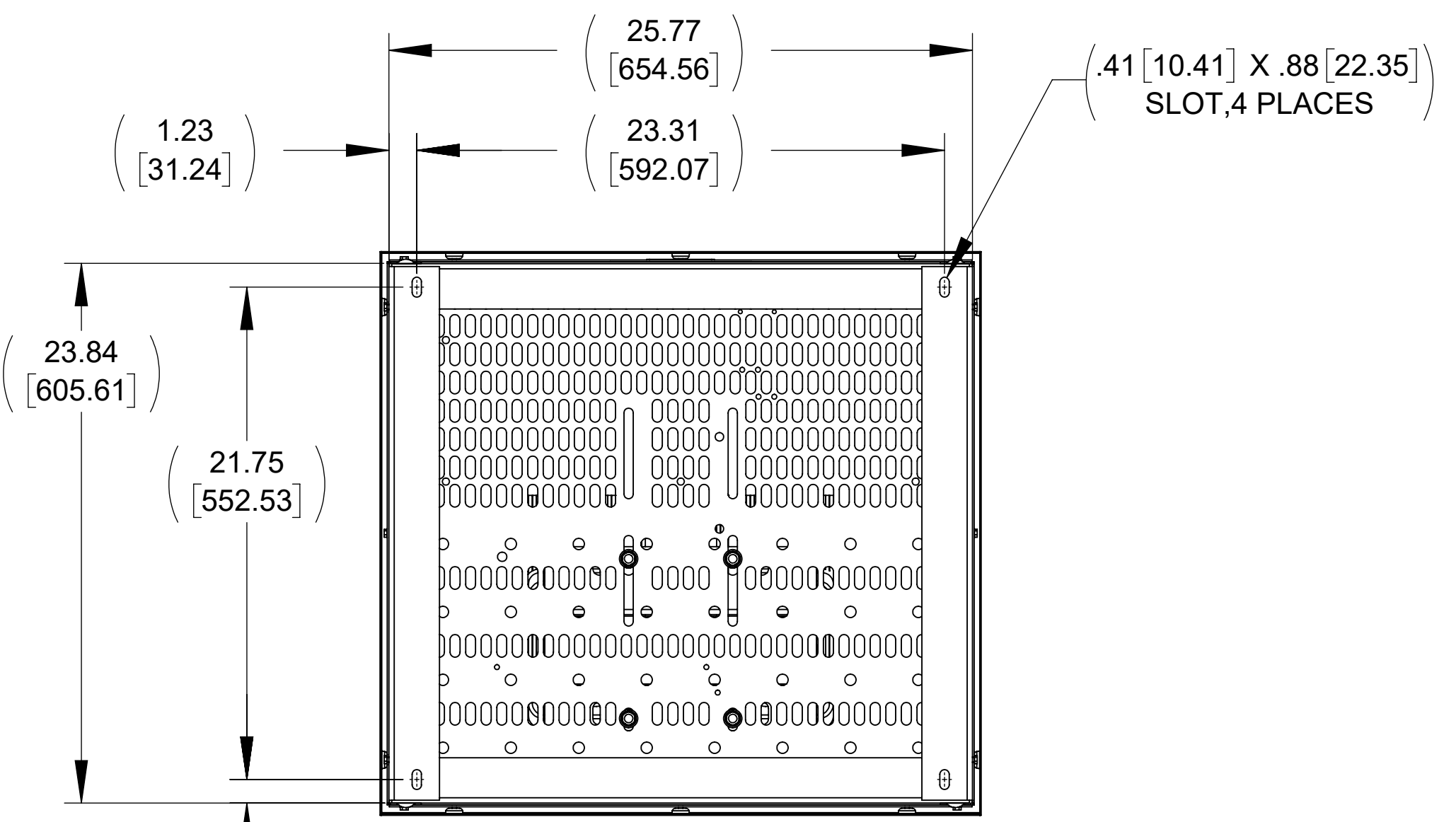

BOTTOM VIEW

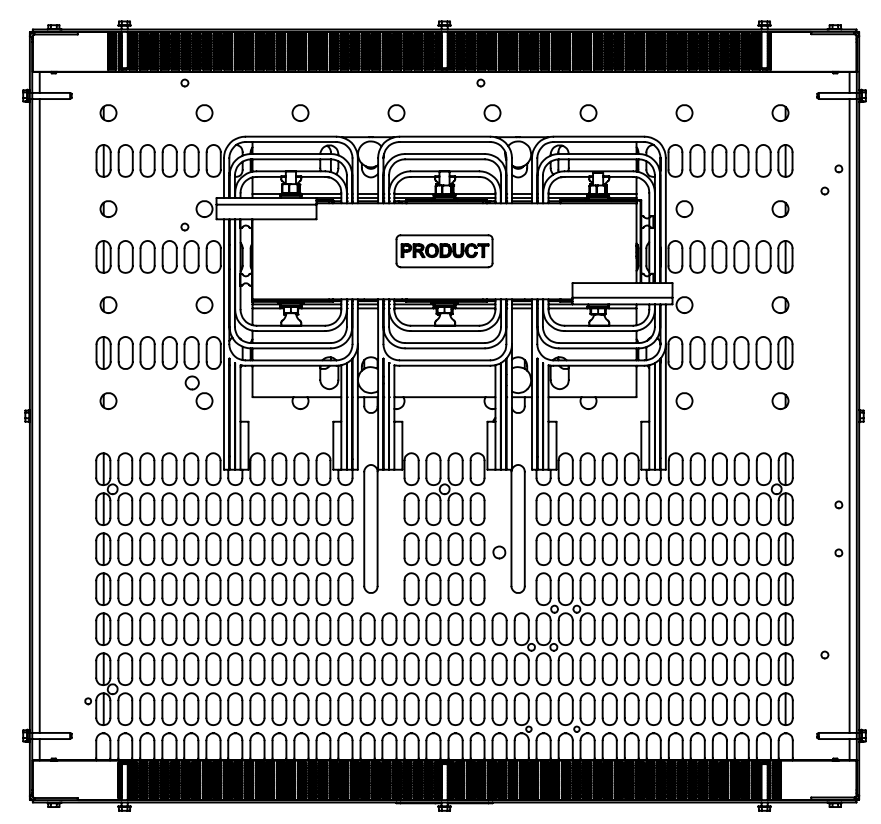

TOP VIEW (PANEL REMOVED)

NOTES:

1. REFER TO USER MANUAL FOR COMPLETE INSTALLATION INSTRUCTIONS.

THE COMPONENT, PART OR ASSEMBLY DESCRIBED IN THIS DOCUMENT MUST COMPLY WITH THE EU (EUROPEAN UNION) DIRECTIVE RoHS2 CONTAINS <0.1% OF ANY SVHC BY WEIGHT PER REACH REGULATION		MATERIAL		CONFIDENTIAL AND PROPRIETARY INFORMATION THIS DOCUMENT CONTAINS CONFIDENTIAL AND PROPRIETARY INFORMATION OF MTE CORPORATION AND MAY NOT BE USED, COPIED OR DISCLOSED TO OTHERS EXCEPT WITH THE AUTHORIZED WRITTEN PERMISSION OF MTE CORPORATION	
UNLESS OTHERWISE SPECIFIED DIMENSIONS ARE IN INCHES (MM) TOLERANCES ARE: ANGLES: ± 1° 1 PLACE .X: ± .1 [2.5] 2 PLACE .XX: ± .03 [0.76] 3 PLACE .XXX: ± .010 [0.254]		DRAWN WF DATE 01/22/20 CHECKED WF DATE 01/23/20 APPROVED PY DATE 01/24/20		DESCRIPTION LINE/LOAD REACTOR w/ENCLOSURE	
Rockwell Automation		SIZE D DWG No. CD 1321-3RA750-A REV 00		SCALE 1:6 SHEET 1 OF 1	