

APPROX. WEIGHT (LBS)
345

ECO No	DESCRIPTION	REV BY	DATE

CRITICAL TO QUALITY CLASSIFICATION TABLE				
<small> P-PROFORMANCE FIT ASSEMBLY I-IDENTIFIABLE CLASSIFICATIONS E-ENGINEERING MANUFACTURING REQUIREMENT R-REGULATORY COMPLIANCE MANDATORY </small>				
COMMENTS	DRAWING ZONE	P	F	R
ROHS	G1-H1			X

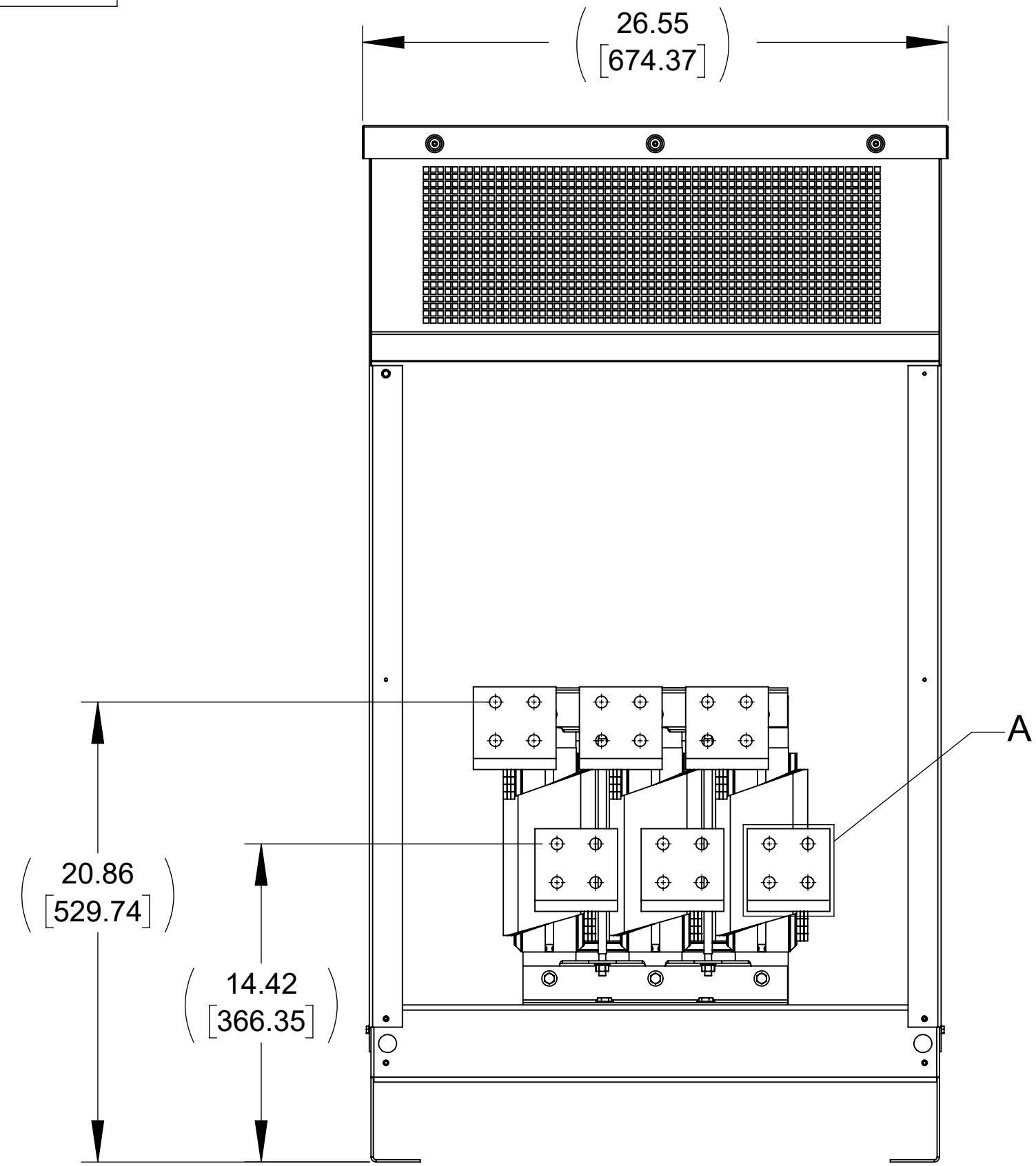

**FRONT VIEW
(PANEL REMOVED)**

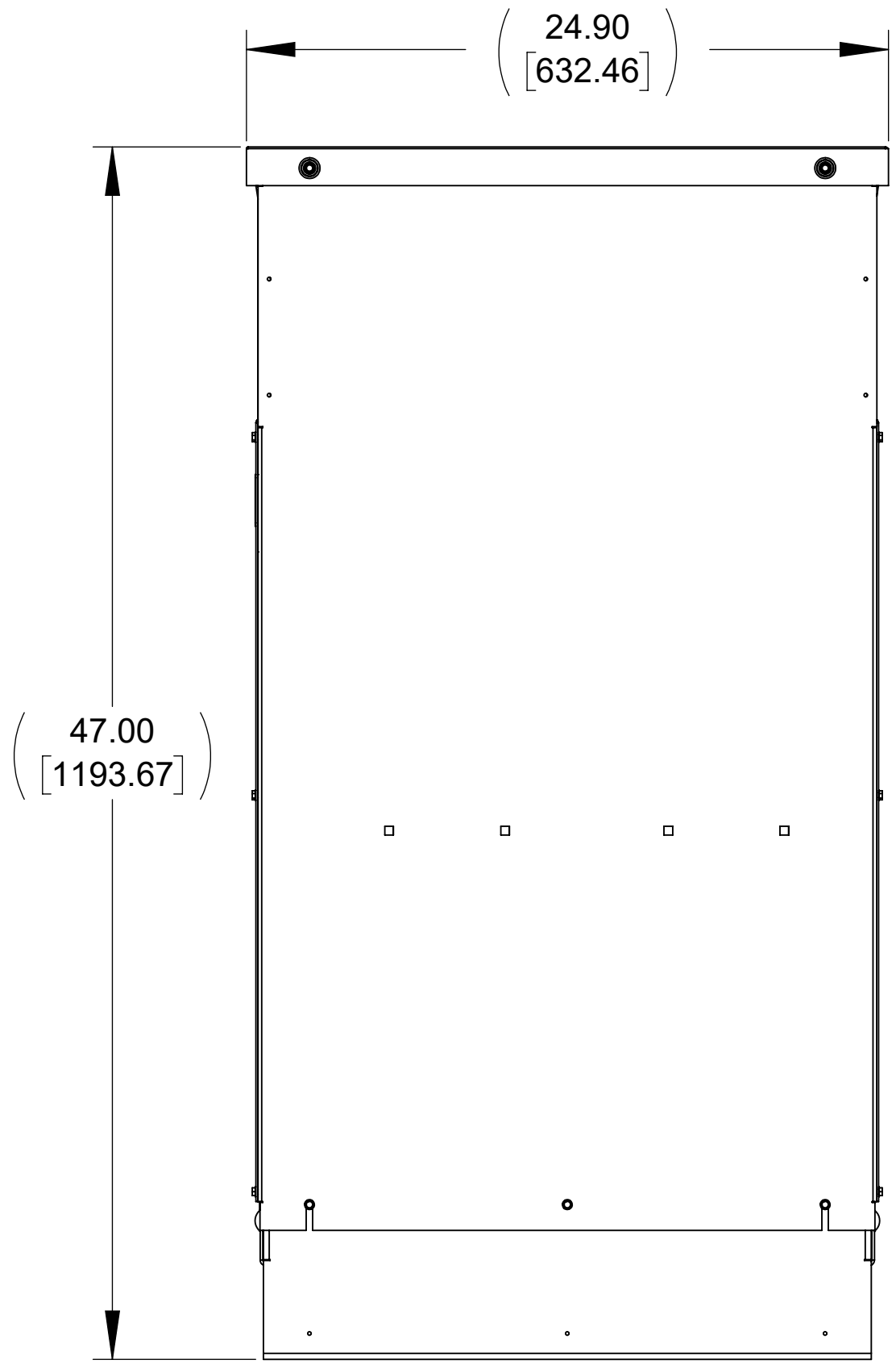

SIDE VIEW

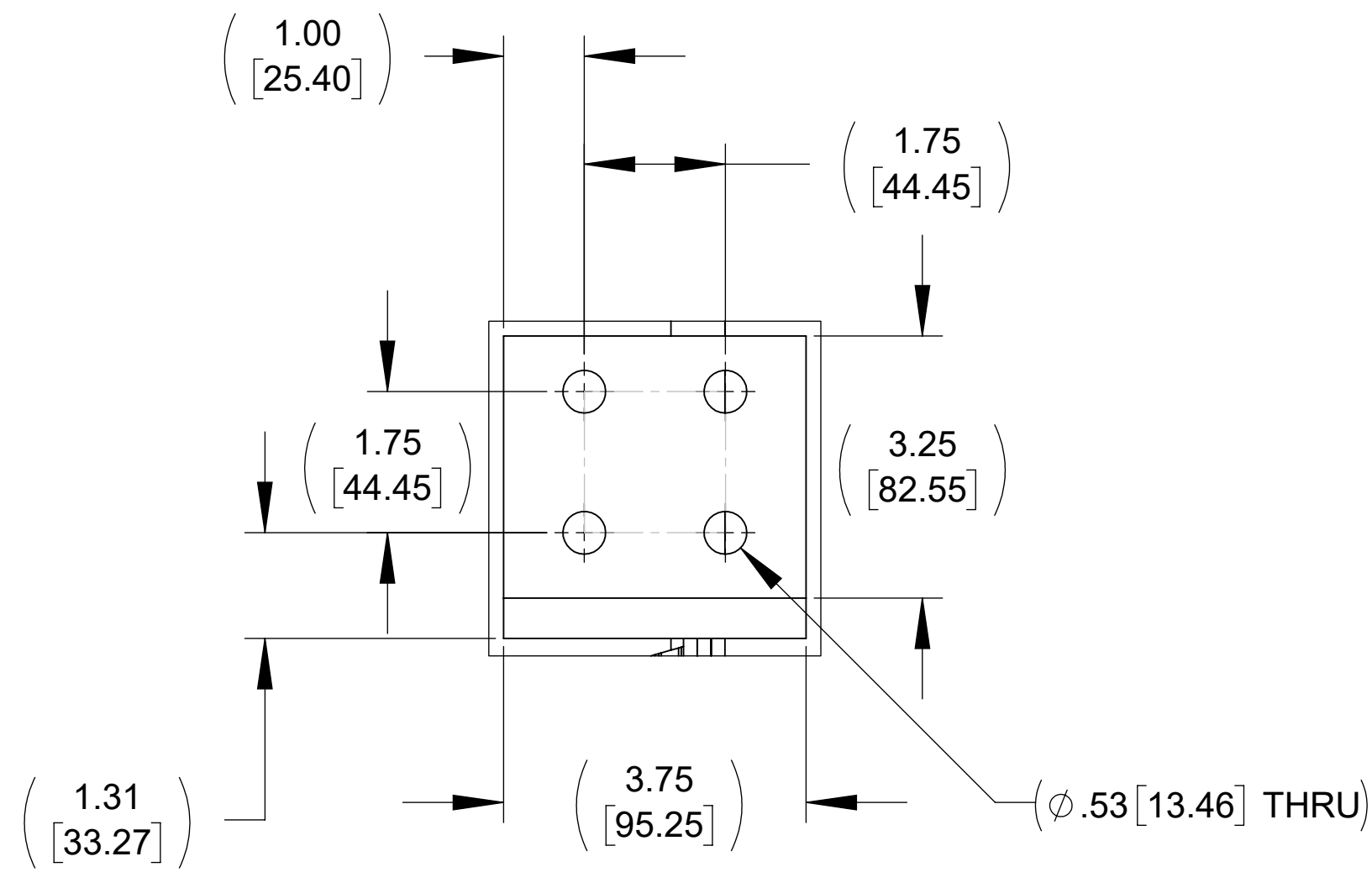
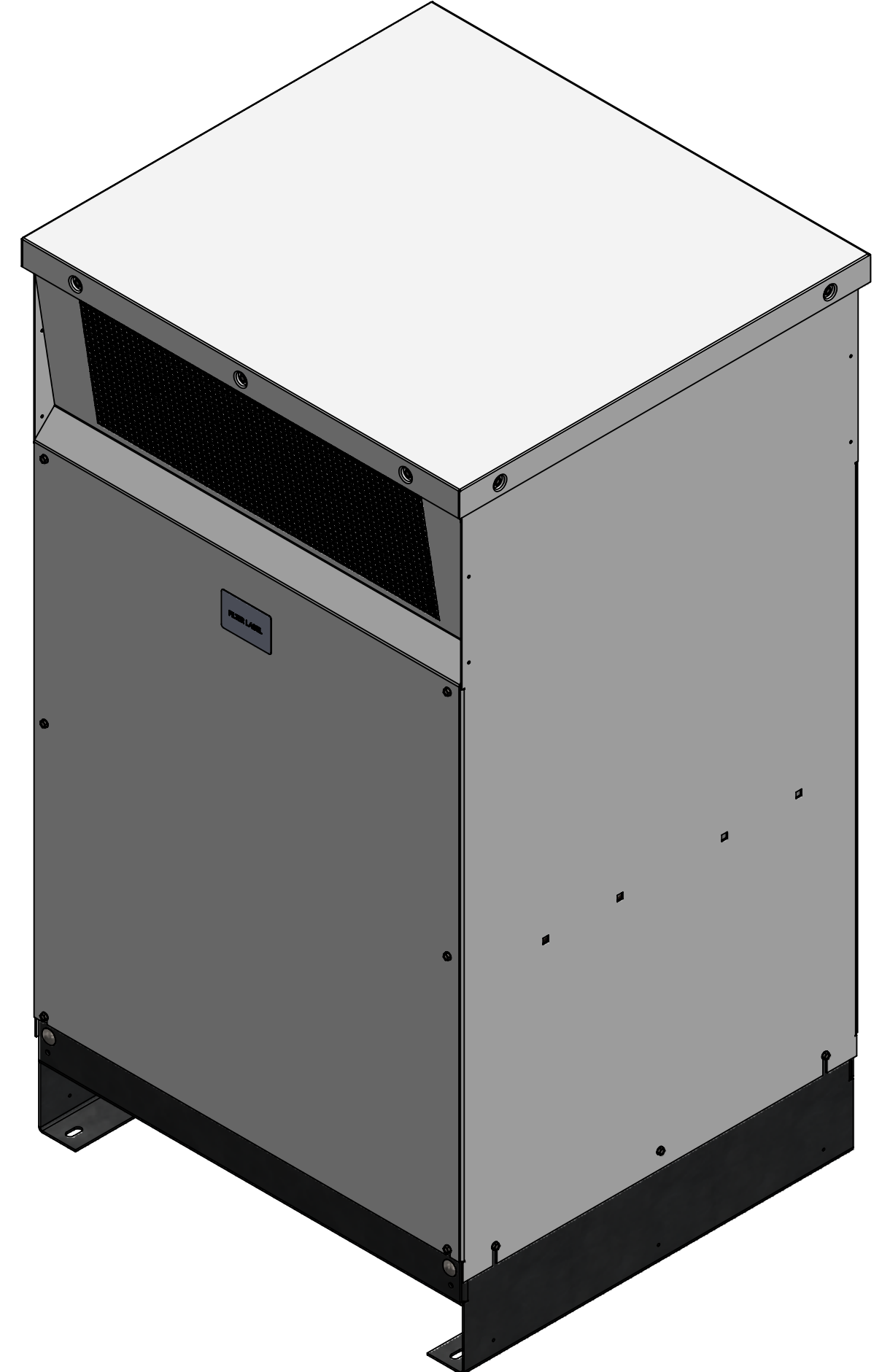

**DETAIL A
(6 PLACES)**

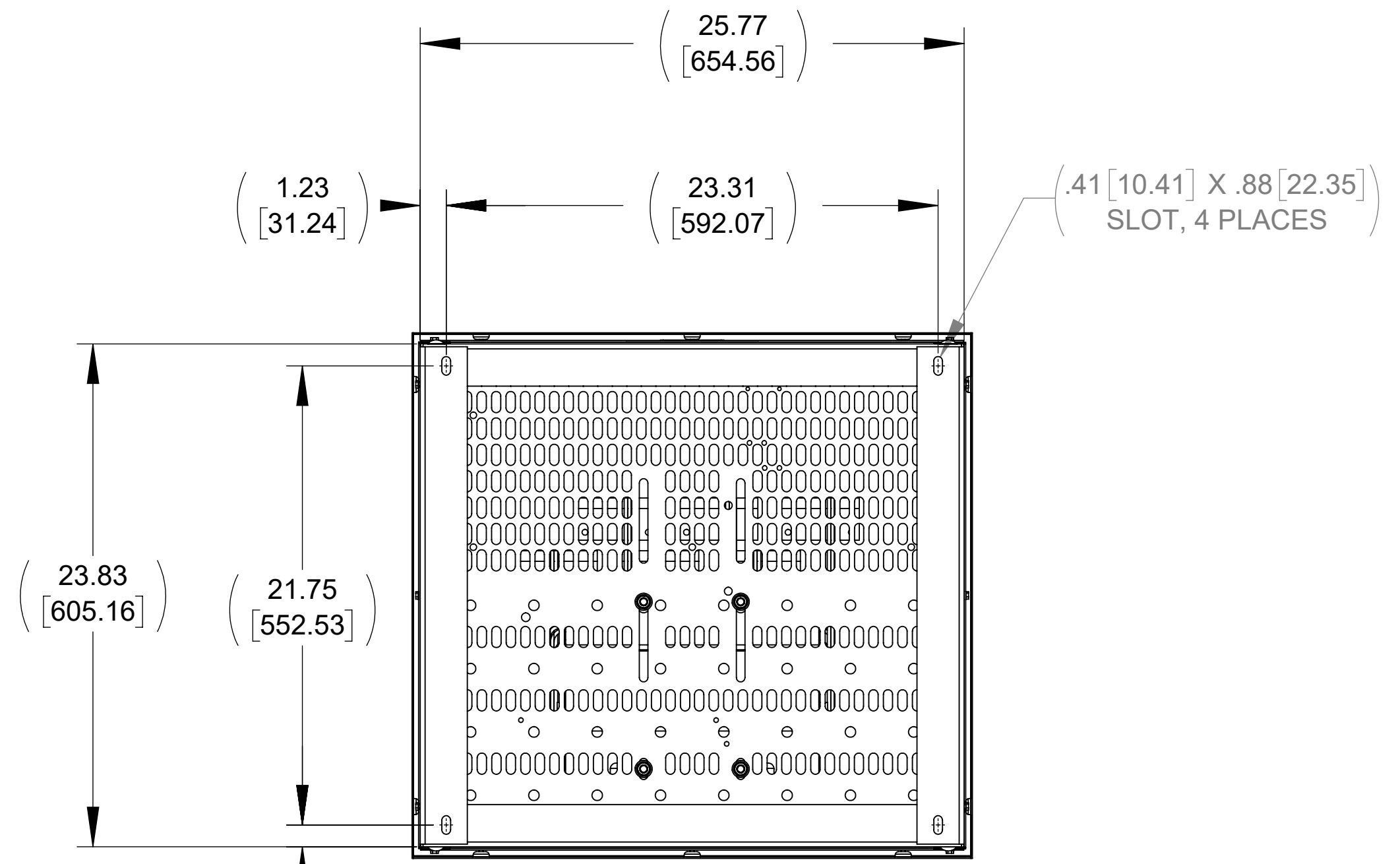

BOTTOM VIEW

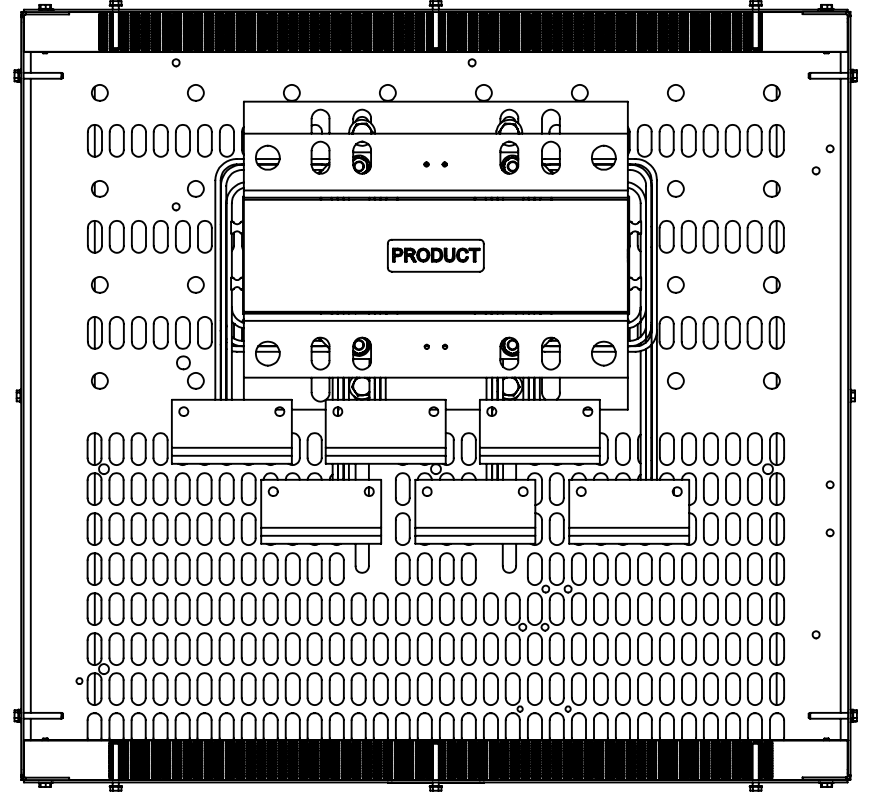

**TOP VIEW
(PANEL REMOVED)**

NOTES:

1. REFER TO USER MANUAL FOR COMPLETE INSTALATION INSTRUCTION.

THE COMPONENT, PART OR ASSEMBLY DESCRIBED IN THIS DOCUMENT MUST COMPLY WITH THE EU (EUROPEAN UNION) DIRECTIVE ROHS2 CONTAINS <0.1% OF ANY SVHC BY WEIGHT PER REACH REGULATION		MATERIAL		CONFIDENTIAL AND PROPRIETARY INFORMATION THIS DOCUMENT CONTAINS CONFIDENTIAL AND PROPRIETARY INFORMATION OF MTE CORPORATION AND MAY NOT BE USED, COPIED OR DISCLOSED TO OTHERS EXCEPT WITH THE AUTHORIZED WRITTEN PERMISSION OF MTE CORPORATION	
UNLESS OTHERWISE SPECIFIED DIMENSIONS ARE IN INCHES [MM] TOLERANCES ARE: ANGLES: ± 1 ° 1 PLACE .X: ± .1 [2.5] 2 PLACE .XX: ± .03 [0.76] 3 PLACE .XXX: ± .010 [0.254]				DESCRIPTION LINE/LOAD REACTOR w/ENC	
DRAWN WF	DATE 01/22/20	CHECKED WF	DATE 01/23/20	SIZE D	DWG No. CD 1321-3RA850-A
APPROVED PY	DATE 01/24/20	SCALE 1:6		REV 00	SHEET 1 OF 1