

INSULATION BACK PLATE 4POLE ASSEMBLY

ITEM	DESCRIPTION	QTY	AB CAT NUMBER
1	MOLDED CASE CIRCUIT BREAKER	1	140G-1-4P CB
2	INSULATION BACK PLATE 4POLE (2 PCS)	1 SET	140G-1-BP4

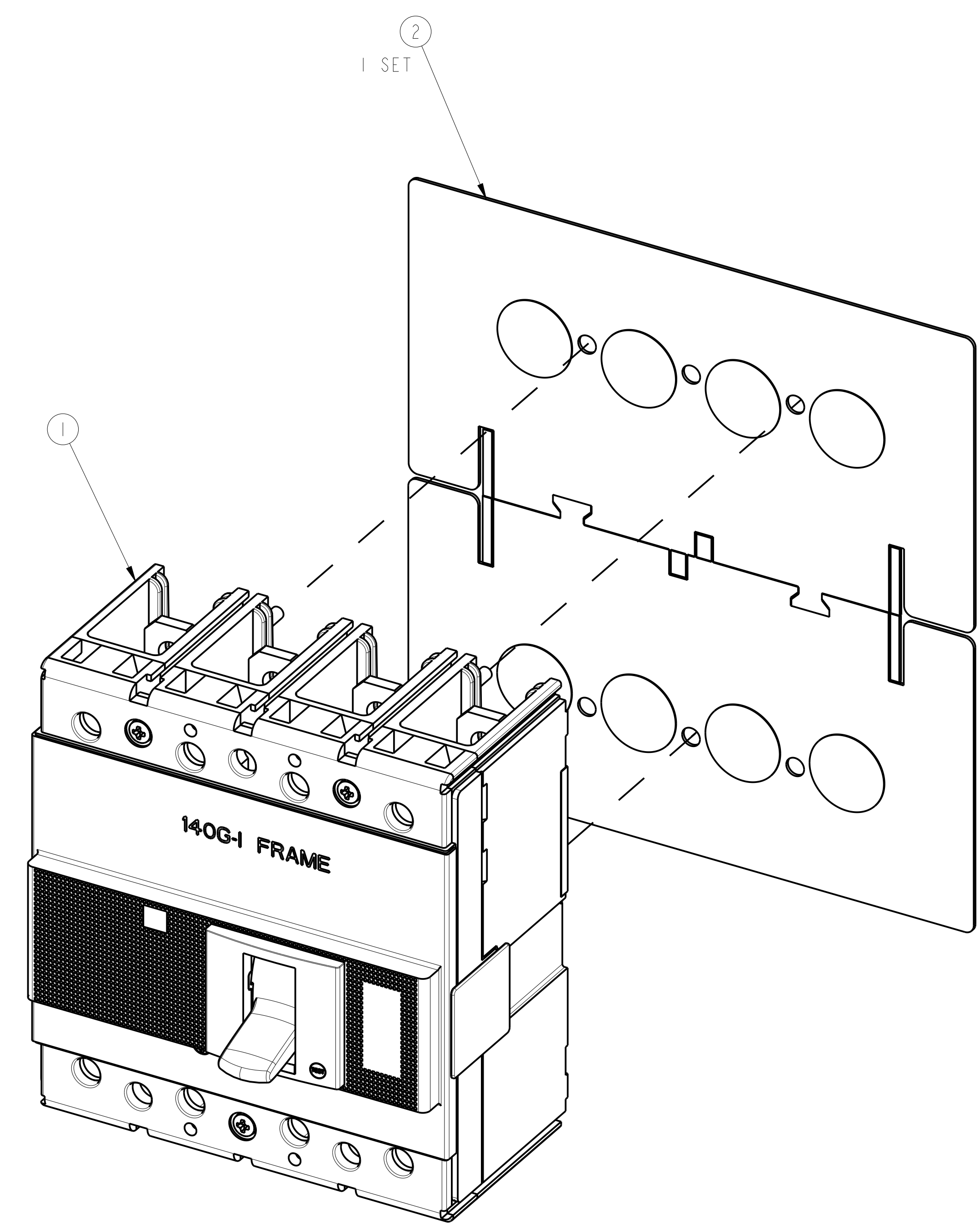
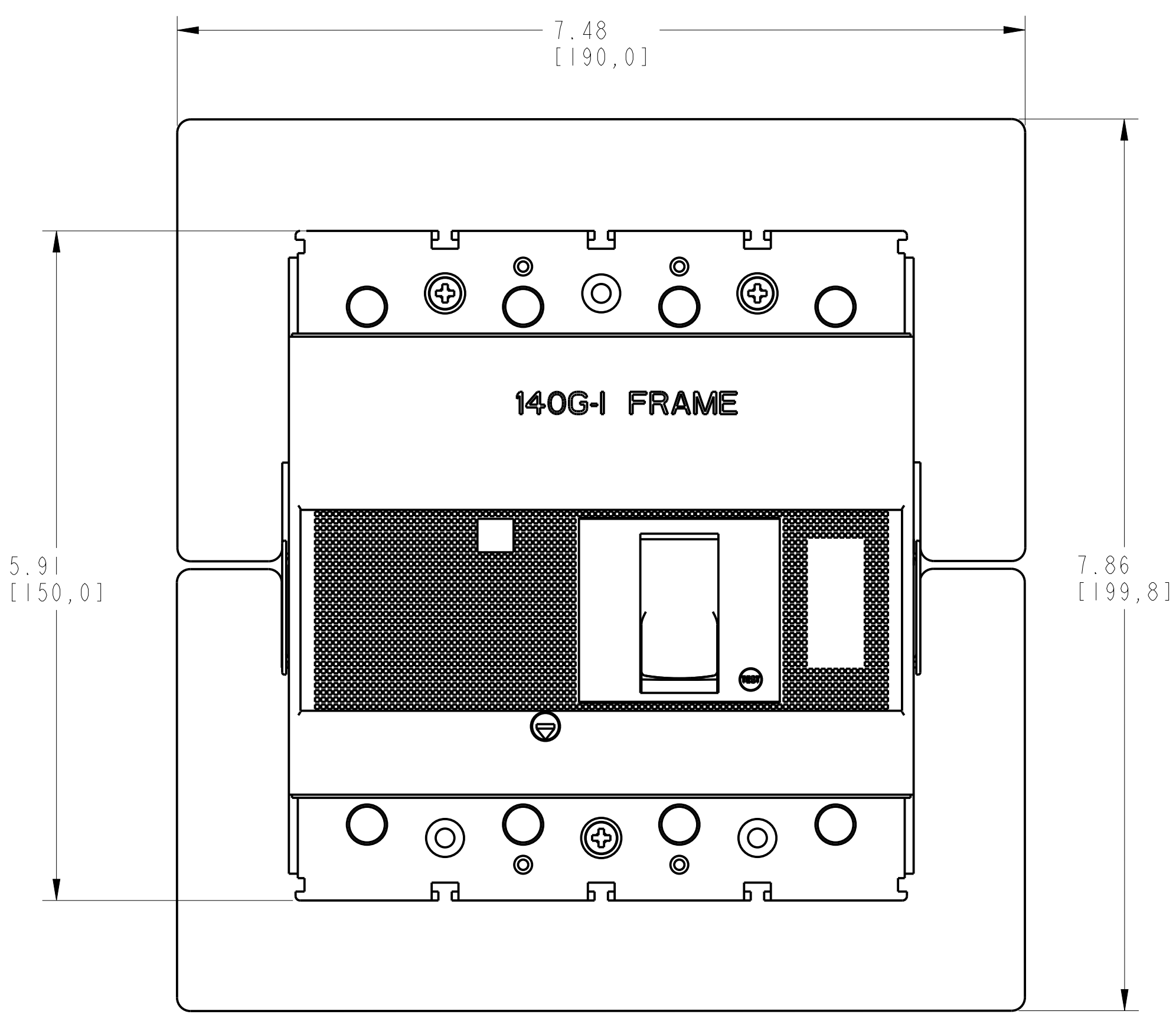
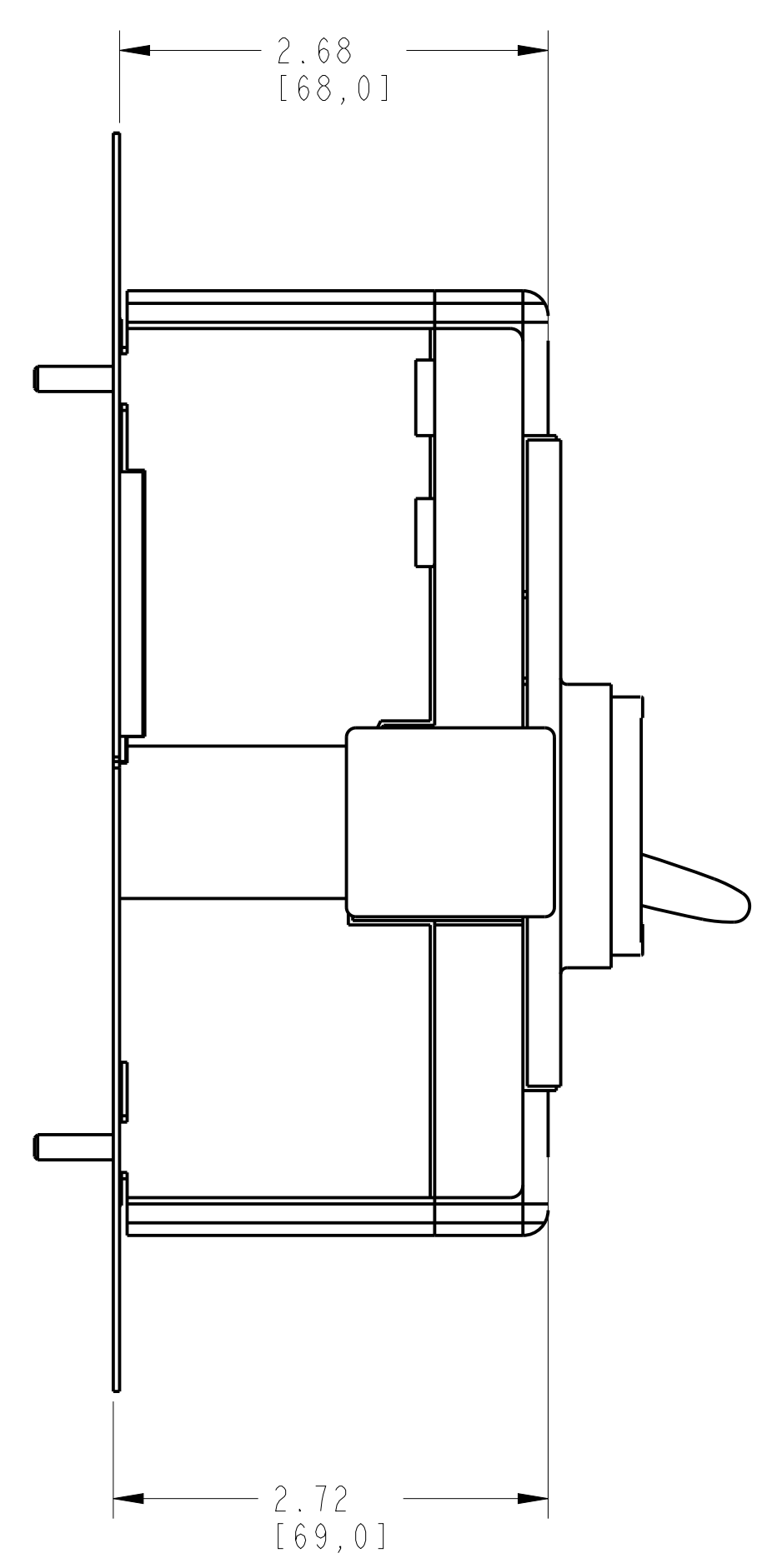
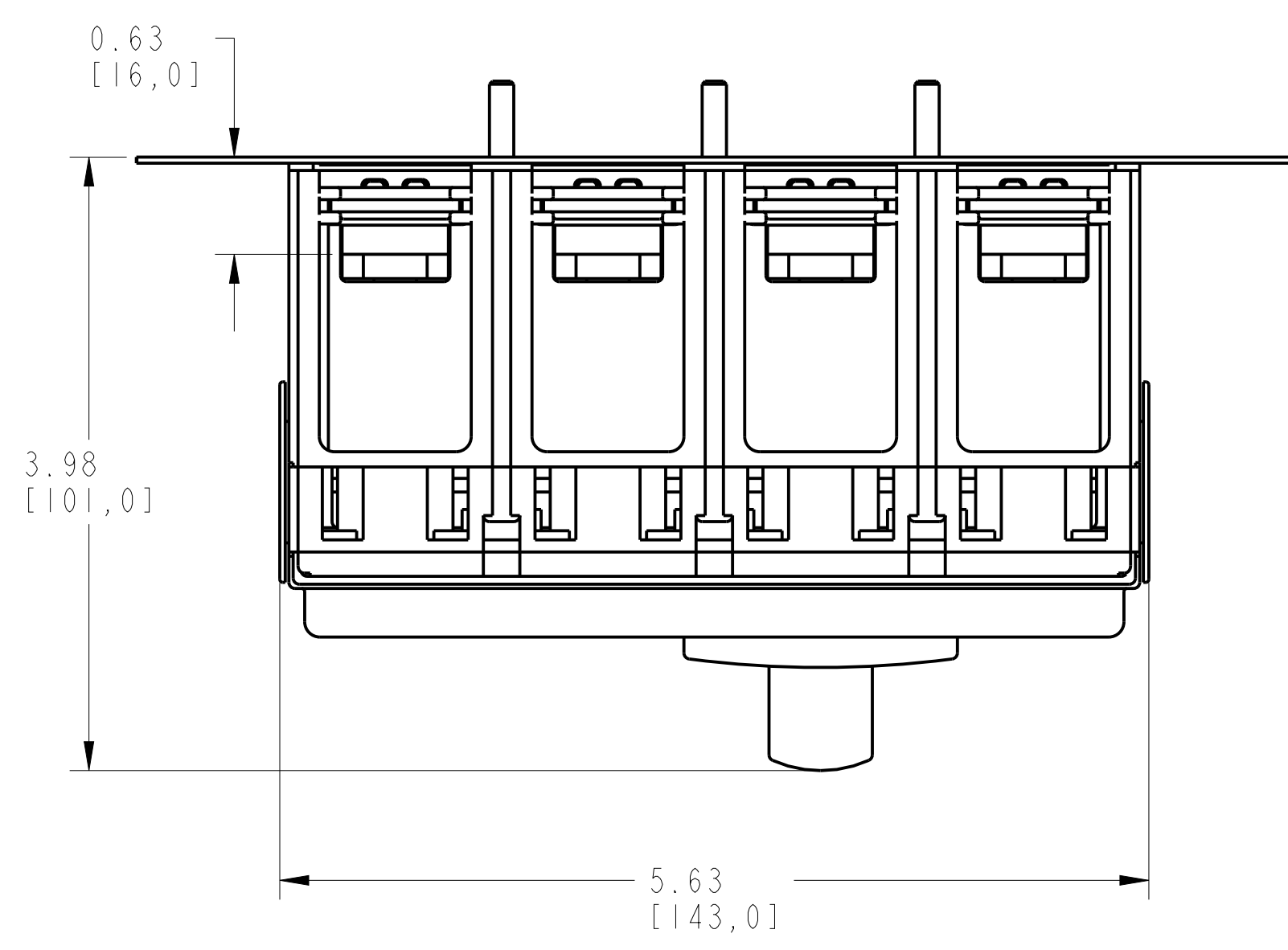

INSULATION BACK PLATE 4 POLE ASSEMBLED TO 140G-1-4-POLE
SCALE 1:1

		<small>CONFIDENTIAL AND PROPRIETARY INFORMATION. THIS DOCUMENT CONTAINS CONFIDENTIAL AND PROPRIETARY INFORMATION OF ROCKWELL AUTOMATION, INC. AND MAY NOT BE USED, COPIED OR DISCLOSED TO OTHERS, EXCEPT WITH THE AUTHORIZED WRITTEN PERMISSION OF ROCKWELL AUTOMATION, INC.</small>	
		Sheet 1 Of 2	
INSULATION BACK PLATE 4POLE ASSEMBLED TO 140G-1-4P CB		Size D	Ver 00
Drawn by: UMUNUSW	Date: 10-21-13	1000853563	

1 2 3 4 5 6 7 8

A
B
C
D
E
F
G
H

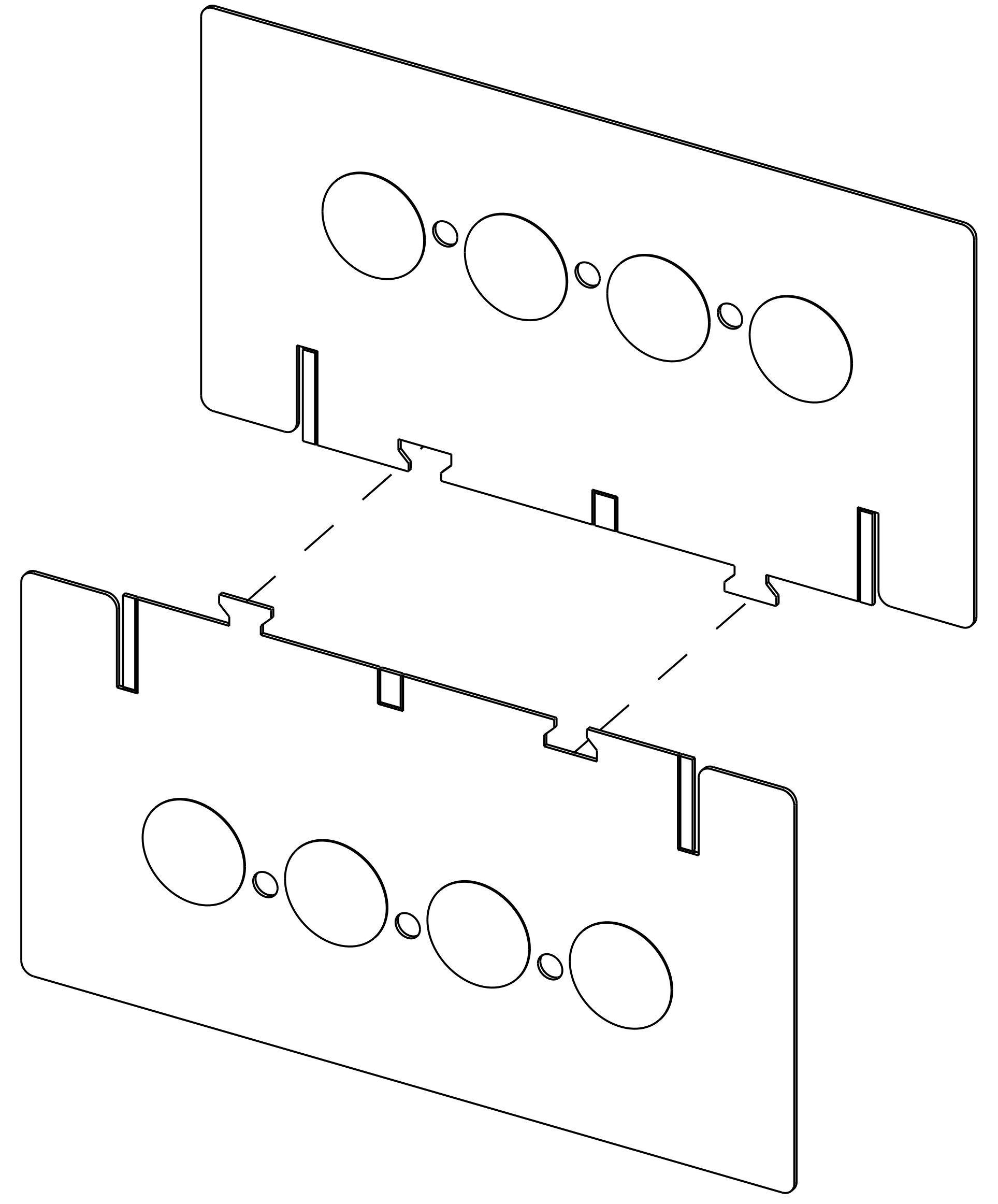
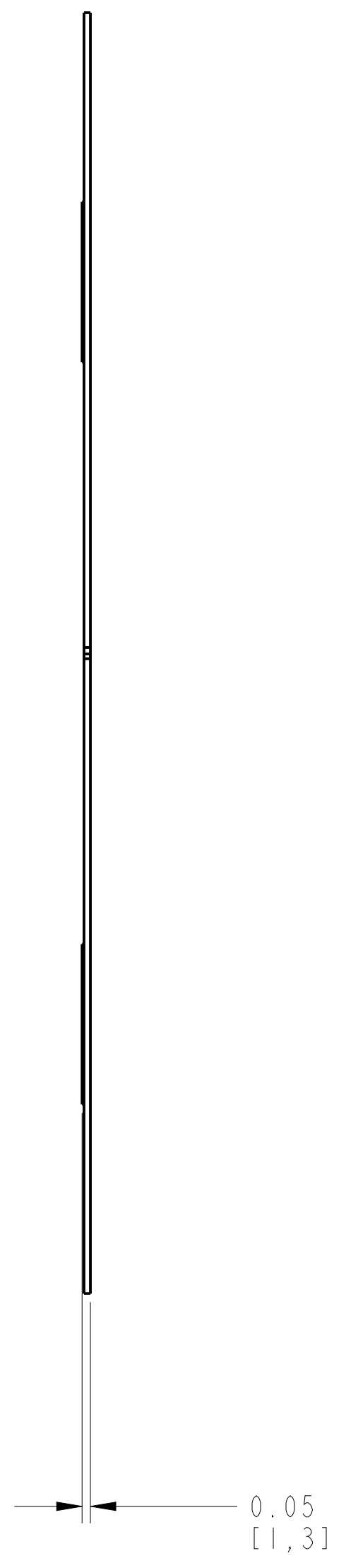
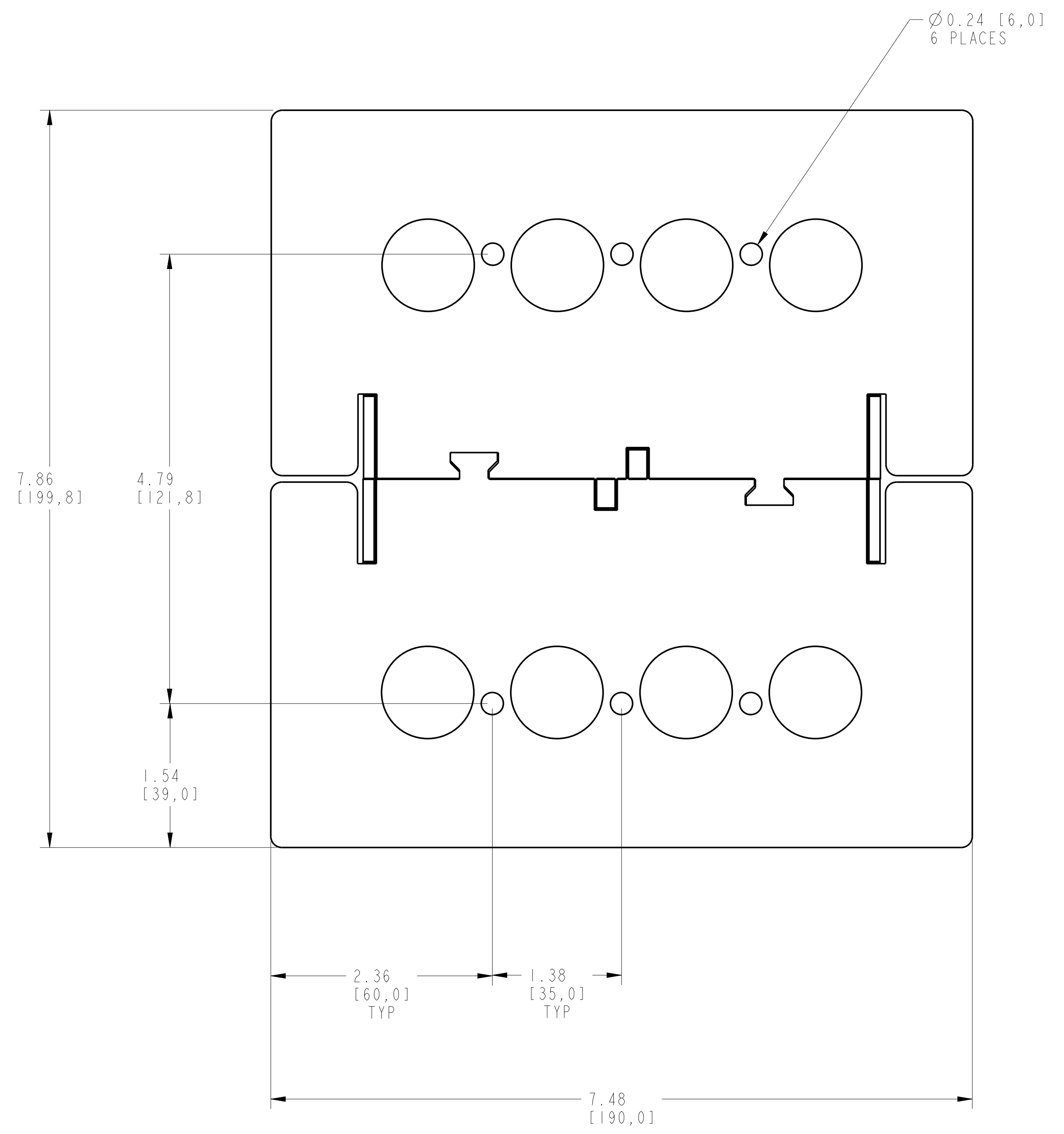

ITEM 2 : INSULATION BACK PLATE 4POLE
SCALE 1.2:1

		<small>CONFIDENTIAL AND PROPRIETARY INFORMATION THIS DOCUMENT CONTAINS CONFIDENTIAL AND PROPRIETARY INFORMATION OF ROCKWELL AUTOMATION, INC. AND MAY NOT BE USED, COPIED OR DISCLOSED TO OTHERS, EXCEPT WITH THE AUTHORIZED WRITTEN PERMISSION OF ROCKWELL AUTOMATION, INC.</small>	
		Sheet 2 Of 2	
INSULATION BACK PLATE 4POLE ASSEMBLED TO 140G4-4P CB		Size D	Ver 00
Drawn by: UMUNUSW	Date: 10-21-13	10000853563	