

CRITICAL TO QUALITY CLASSIFICATION TABLE				
P=PERFORMANCE, F=FIT, A=ASSEMBLY				
X=IDENTIFIES APPLICABLE CLASSIFICATION(S)				
◇=ENGINEERING AND/OR MANUFACTURING REQUIREMENT				
⊙=REGULATORY REQUIREMENT-CONFORMANCE IS MANDATORY				
COMMENTS	DRAWING ZONE	◇	◇	◇
ROHS	GI-HI			X

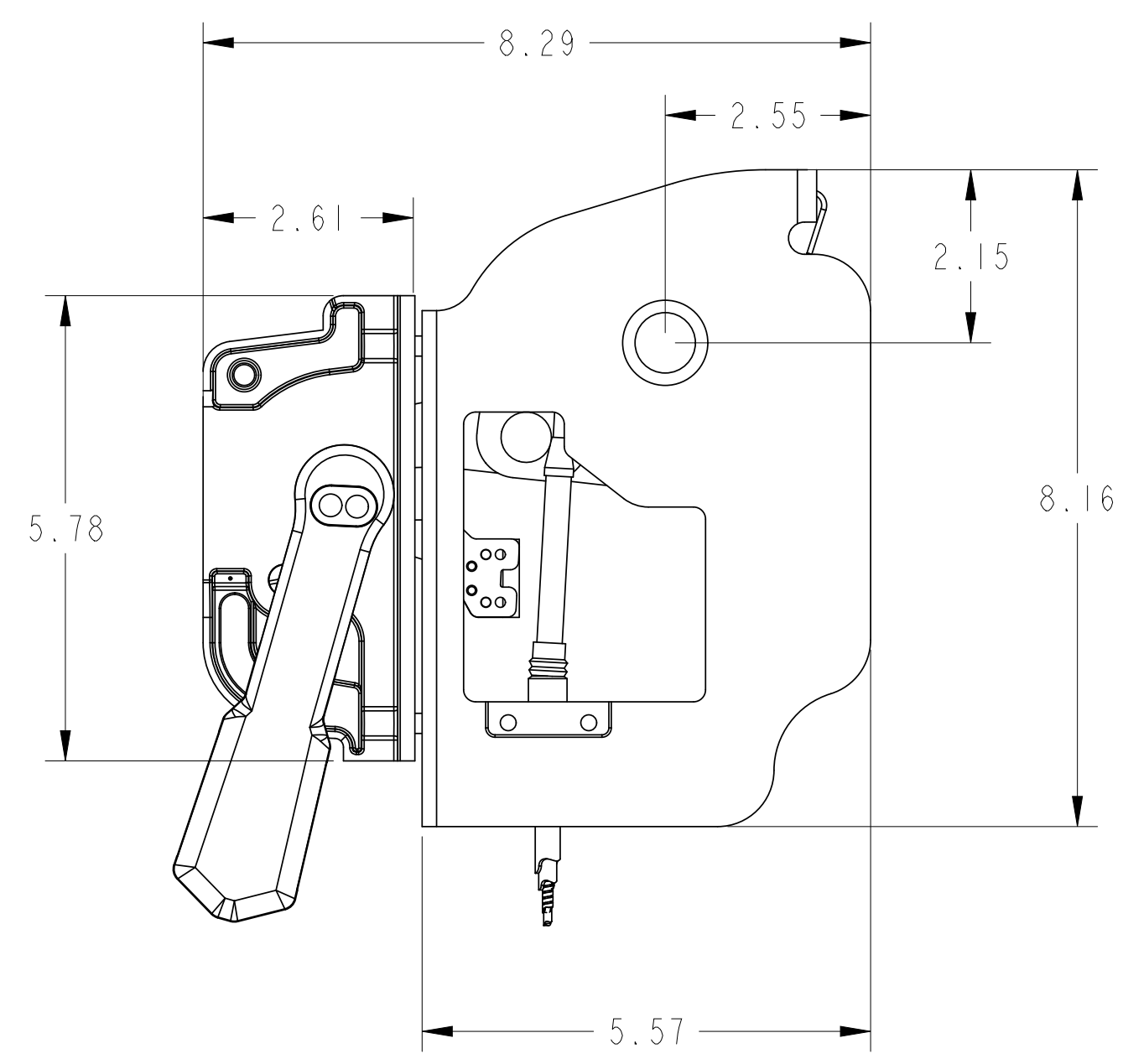
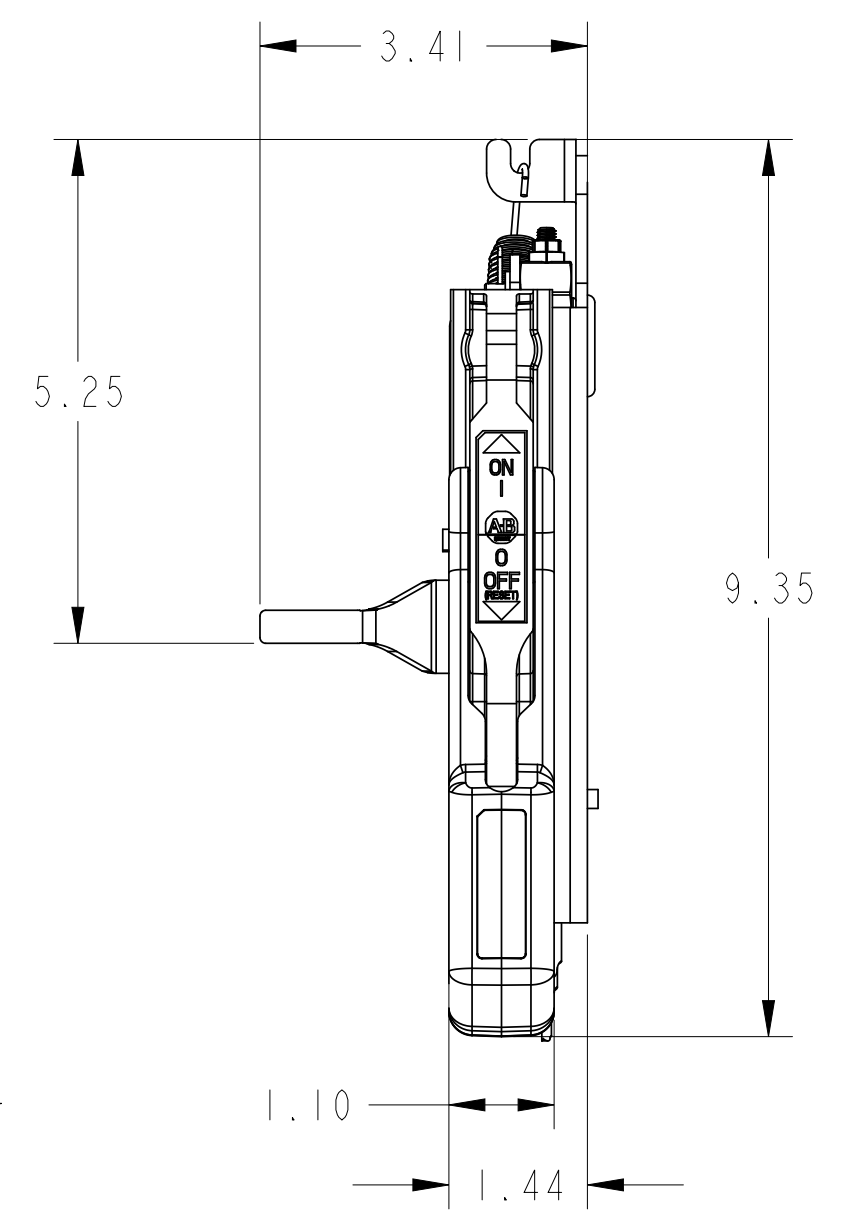
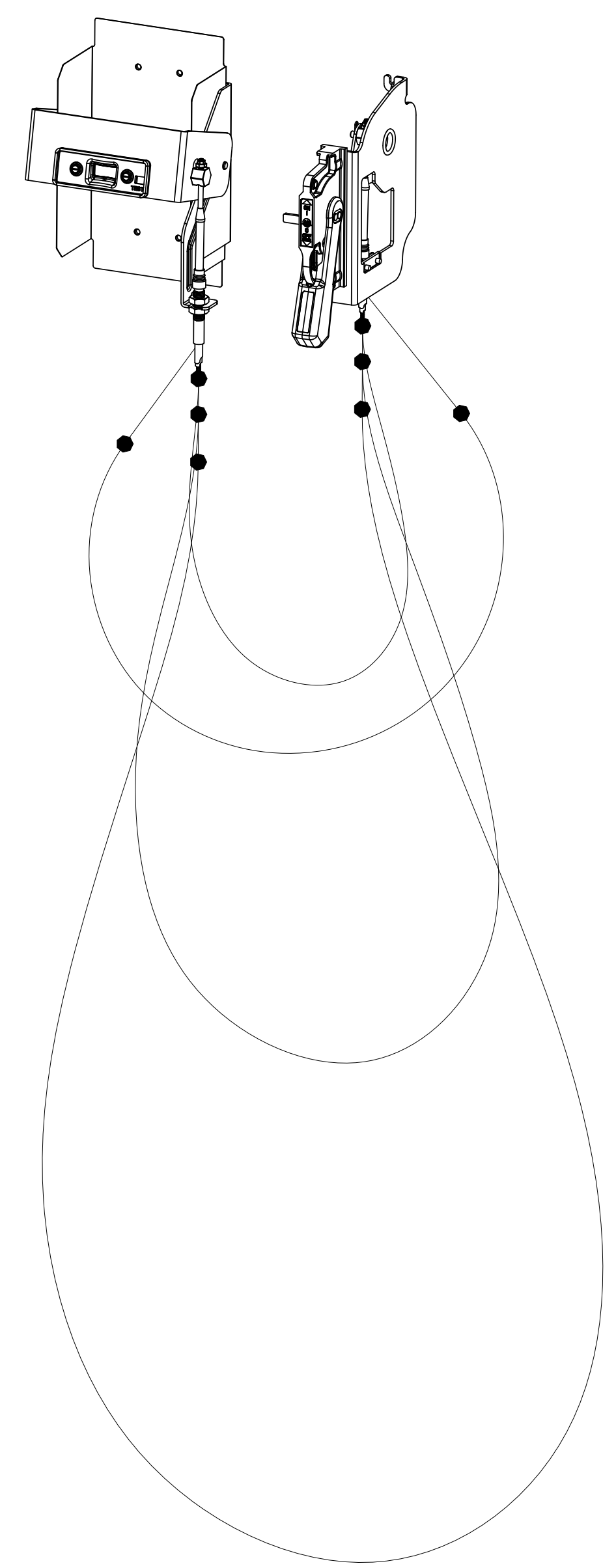
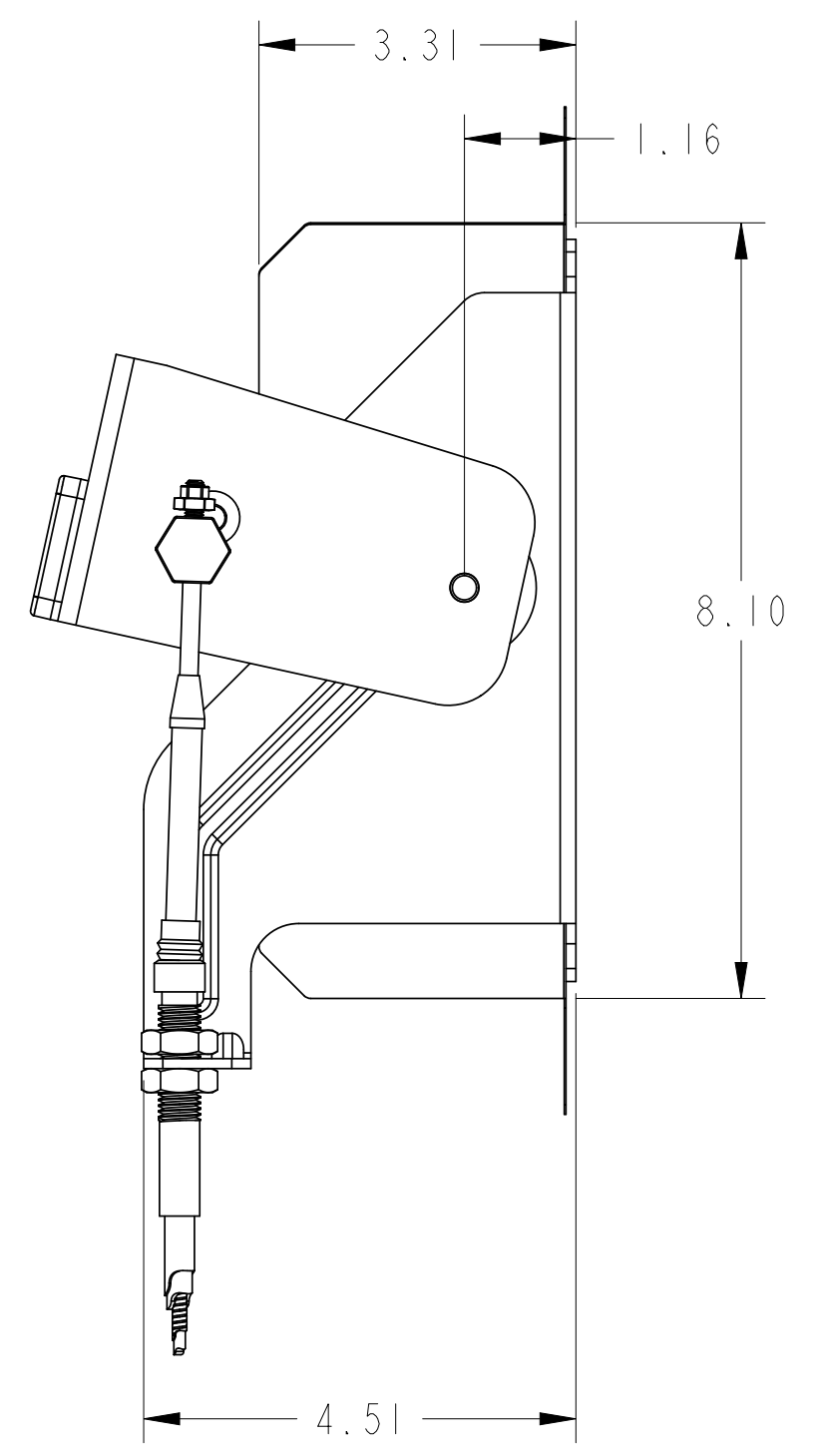
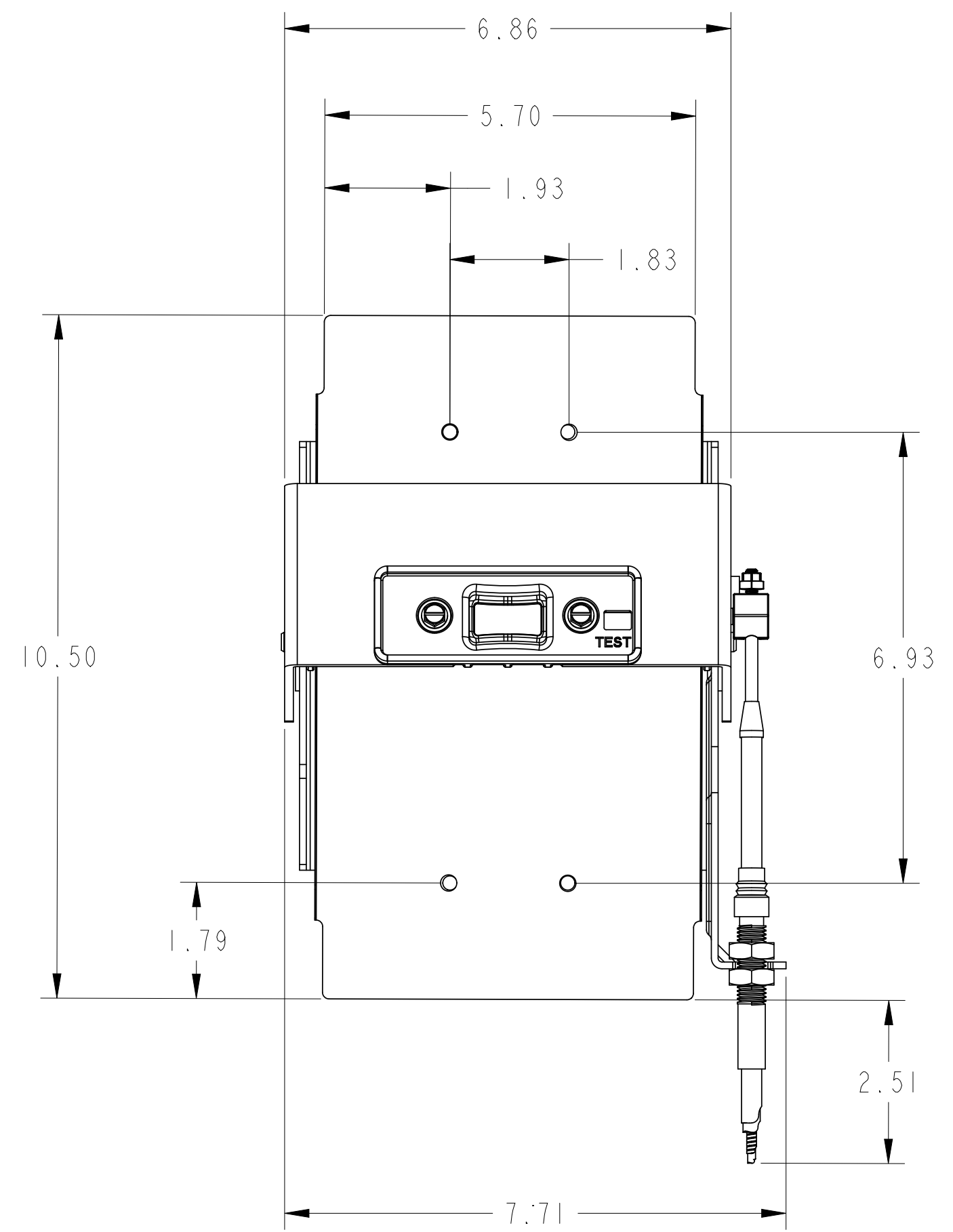

This flexible model can be used for 4 different cable length:
Please select flexible while assembling and then suppressed/resumed cable part as per required length:

Cable Length	Bending Diameter (Min.)
3 ft (0.91 m)	6.0" (152.4 mm)
4 ft (1.3 m)	6.0" (152.4 mm)
6 ft (1.9 m)	6.0" (152.4 mm)
10 ft (3.0 m)	6.0" (152.4 mm)

MUST COMPLY WITH ROCKWELL AUTOMATION ENVIRONMENTAL SPECIFICATION 970-20-01

WORKMANSHIP STANDARDS	FINISH	MATERIAL	10007625562	PART/MMR NUMBER
ALL UNDIMENSIONED GEOMETRIES ARE CONTROLLED BY THE CAD MODEL. IN CASE OF DIMENSION DISCREPANCY, CAD MODEL OVERRIDES.			CONFIDENTIAL AND PROPRIETARY INFORMATION. THIS DOCUMENT CONTAINS CONFIDENTIAL AND PROPRIETARY INFORMATION OF ROCKWELL AUTOMATION, INC. AND MAY NOT BE USED, COPIED OR DISCLOSED TO OTHERS, EXCEPT WITH THE AUTHORIZED WRITTEN PERMISSION OF ROCKWELL AUTOMATION, INC.	
FIRST ANGLE PROJECTION	DESCRIPTION		DATE: 2024-05-16	SHEET 1 OF 1
	DRW FLEX CABLE OPERATOR, K-FRAME	SIZE	D	VER
	CREATED BY: P.Koczmarczyk	CHANGED BY: -	10007970278	00