

CRITICAL TO QUALITY CLASSIFICATION TABLE					
P=PERFORMANCE, F=FIT, A=ASSEMBLY X=IDENTIFIES APPLICABLE CLASSIFICATION(S) ⬠=ENGINEERING AND/OR MANUFACTURING REQUIREMENT ®=REGULATORY REQUIREMENT-CONFORMANCE IS MANDATORY					
COMMENTS	DRAWING ZONE	P	F	A	R
ROHS	G1-H1				X

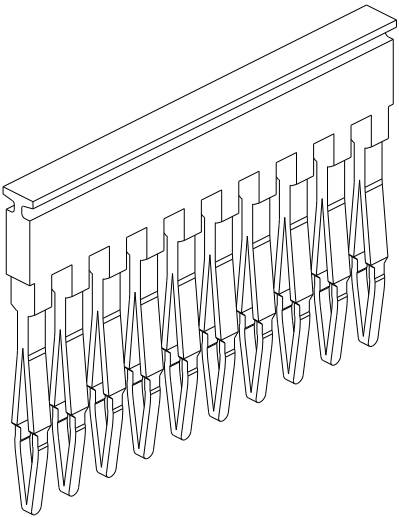

MUST COMPLY WITH ROCKWELL  
AUTOMATION ENVIRONMENTAL  
SPECIFICATION 970-20-01

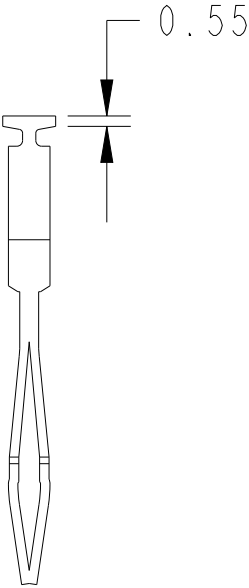
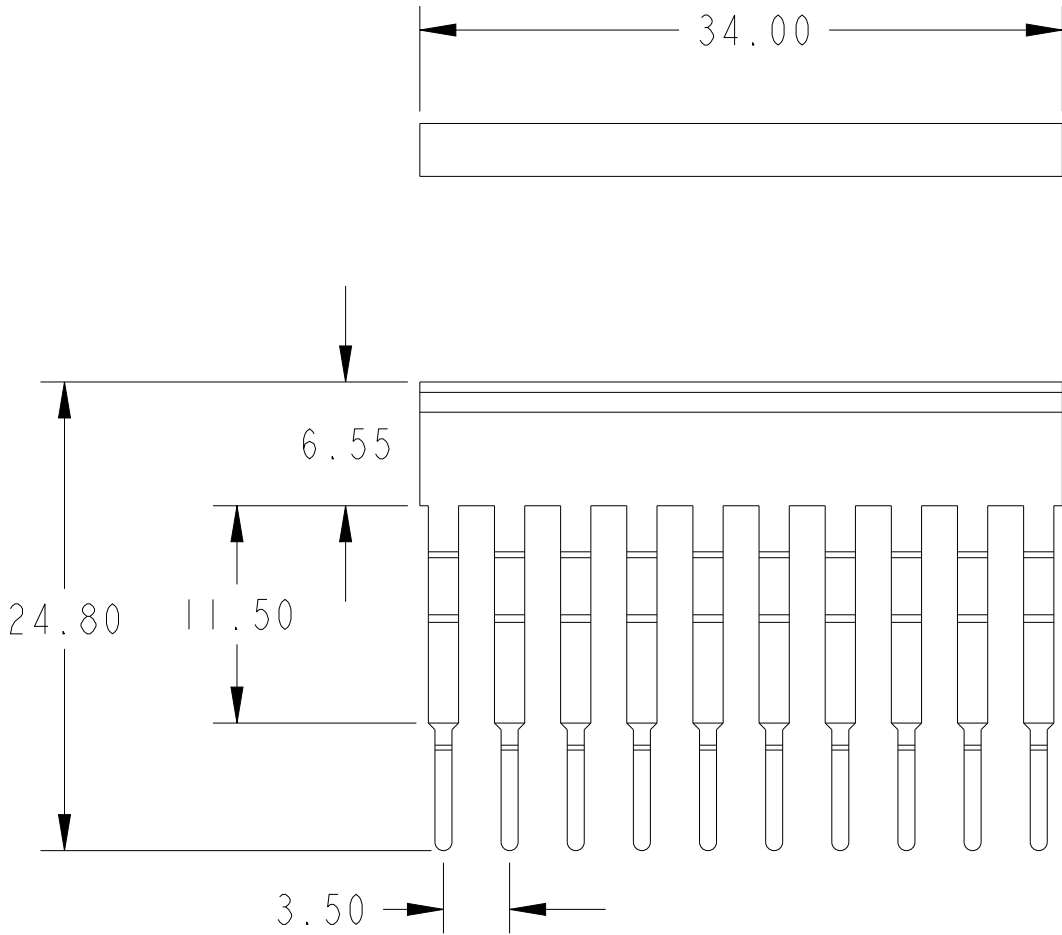

ALL UNDIMENSIONED  
GEOMETRIES ARE  
CONTROLLED BY THE  
CAD MODEL. IN CASE  
OF DIMENSION  
DISCREPANCY, CAD  
MODEL OVERRIDES.

THIRD ANGLE PROJECTION

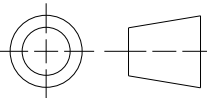

DESCRIPTION



**Rockwell  
Automation**

CONFIDENTIAL AND PROPRIETARY INFORMATION.  
THIS DOCUMENT CONTAINS CONFIDENTIAL AND PROPRIETARY  
INFORMATION OF ROCKWELL AUTOMATION, INC. AND MAY  
NOT BE USED, COPIED OR DISCLOSED TO OTHERS, EXCEPT  
WITH THE AUTHORIZED WRITTEN PERMISSION OF ROCKWELL  
AUTOMATION, INC.

**1492-CJL4-10**

\*\*\*\*\*  
\*\*\*\*\*

DATE: 2020-07-27

SHEET 1 OF 1

SIZE

DIR

VER

**B**

**XXX**

**00**

CREATED BY: NKUMAR23

CHANGED BY: \*\*\*\*\*