

NOTE:

ALL DIMENSIONS ARE IN MM (FOR REFERENCE ONLY)

ALL UNDIMENSIONED GEOMETRIES ARE CONTROLLED BY THE CAD MODEL. IN CASE OF DIMENSION DISCREPANCY, CAD MODEL OVERRIDES.

Rockwell Automation

CONFIDENTIAL AND PROPRIETARY INFORMATION. THIS DOCUMENT CONTAINS CONFIDENTIAL AND PROPRIETARY INFORMATION OF ROCKWELL AUTOMATION, INC. AND MAY NOT BE USED, COPIED OR DISCLOSED TO OTHERS, EXCEPT WITH THE AUTHORIZED WRITTEN PERMISSION OF ROCKWELL AUTOMATION, INC.

THIRD ANGLE PROJECTION

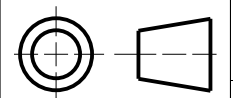

DESCRIPTION **1794 FLEX, FLEX EX, FLEX XT I/O SYSTEM, ANALOG OUTPUT MODULES, 12 SINGLE-ENDED OUTPUTS**

CREATED BY: JKATTUM

CHANGED BY:

DATE: 2019-11-27

SHEET 1 OF 1

SIZE

DIR

VER

A

00