

442L-AMBSZCP2 : SAFEZONE CIP LASER MOUNTING KIT 2

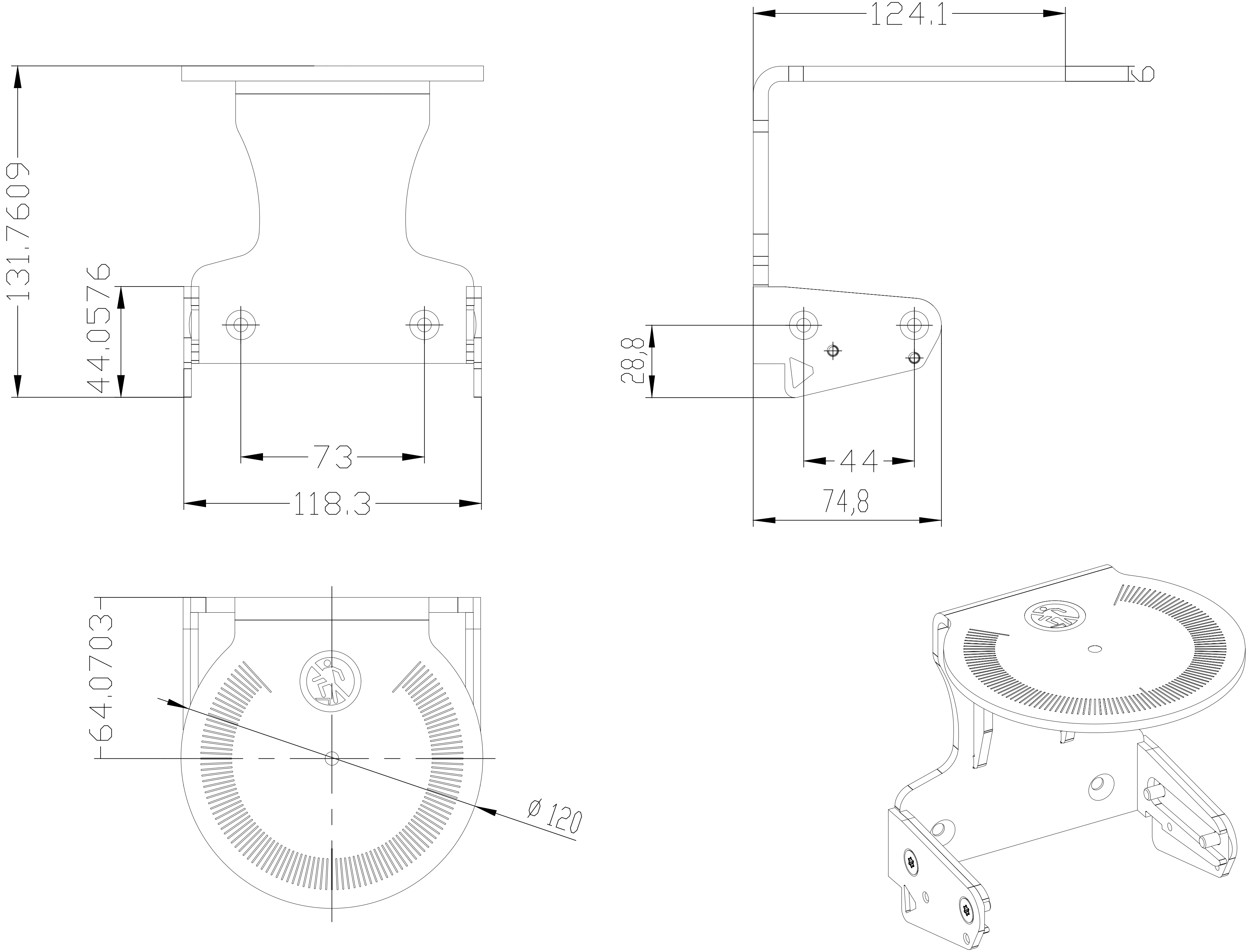

NOTE:  
1. DIMENSIONS ARE IN MM AND ARE FOR REFERENCE ONLY.

CRITICAL TO QUALITY CLASSIFICATION TABLE				
P=PERFORMANCE, F=FIT, A=ASSEMBLY				
X=IDENTITIES APPLICABLE CLASSIFICATION(S)				
◇=ENGINEERING AND/OR MANUFACTURING REQUIREMENT				
Ⓜ=REGULATORY REQUIREMENT - CONFORMANCE IS MANDATORY				
COMMENTS	DRAWING (ZONE)	◇	F	A
ROHS	H1			X

MUST COMPLY WITH ROCKWELL  
SPECIFICATION 910230-01



CONFIDENTIAL AND PROPRIETARY INFORMATION. THIS  
DOCUMENT CONTAINS CONFIDENTIAL AND PROPRIETARY  
INFORMATION OF ROCKWELL AUTOMATION, INC. AND  
MAY NOT BE USED, COPIED OR DISCLOSED TO OTHERS,  
EXCEPT WITH THE AUTHORIZED WRITTEN PERMISSION  
OF ROCKWELL AUTOMATION, INC.

DESCRIPTION	DATE	2020-04-19	SHEET	1	OF	1
SafeZone CIP Scanner Mounting Bracket 2	SIZE	DIR				VER
CREATED BY	SSHARM35	CHANGED BY				