

### Bulletin 500LP 3-Phase Full Voltage Permanent Magnet Latch NEMA Lighting Contactor Sizes 0 through 4 (all series), Size 5 (series L)

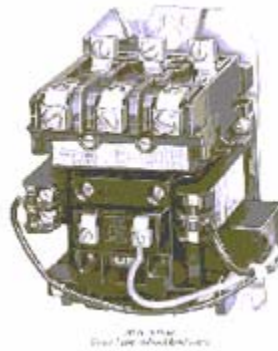

#### Renewal Parts

Figure 1 is an exploded view of the 500LP contactor minus the magnetic latch. Primary parts such as coils and contacts are similar in appearance for all sizes. Secondary parts such as mounting plates will vary in appearance. See page 2 for corresponding description of part and part numbers.

Figure 1

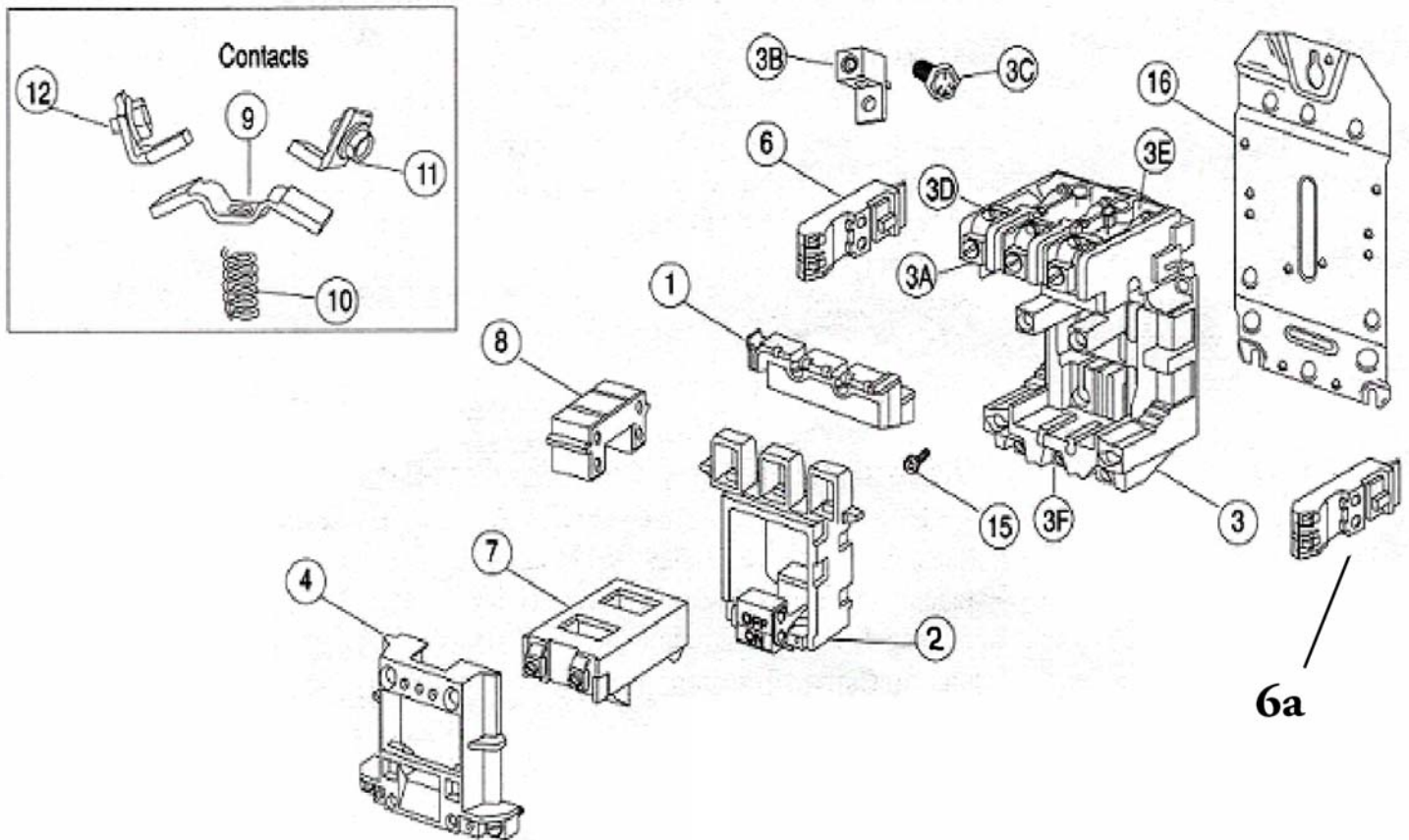

Page 2 contains the corresponding part numbers for the parts illustrated below.

#### Power Pole Adder

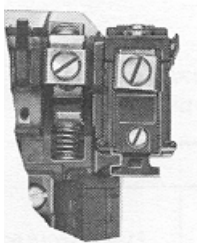

Renewal Parts  
Bulletin 500LP, Sizes 0 through 4, Size 5 (series L)

## Renewal Parts for Figure 1

| Item | Description of Renewal Part   |                | Size 15/20A                    | Size 30A                       | Size 60A                       | Size 100A                      | Size 200A                      | Size 300A<br>(2-3 pole only) |
|------|---|----------------|--------------------------------|--------------------------------|--------------------------------|--------------------------------|--------------------------------|------------------------------|
|      |   |                | Part No.                       | Part No.                       | Part No.                       | Part No.                       | Part No.                       | Part No.                     |
| 1    | Contact Block<br>Cover  | 2 or 4<br>pole | 40410-499-01                   | 40410-499-02                   | 40420-306-56                   | 40430-301-53                   | 40440-308-53                   | 42450-308-53                 |
|      |   | 3 pole         | 40410-499-01                   | 40410-499-02                   | 40420-306-56                   | 40430-457-51                   | 40440-456-51                   | 42450-800-01                 |
| 2    | Movable Contact<br>Support and<br>Armature<br>Assembly ①                              | 2 or 4<br>pole | 40410-806-01                   | 40410-806-02                   | 40420-369-51                   | 40430-806-01                   | 40440-806-01                   | 40440-806-02                 |
|      |   | 3 pole         | 40410-806-01                   | 40410-806-02                   | 40420-806-01                   | 40430-806-01                   | 40440-806-01                   | 40440-806-02                 |
| 3    | Stationary Contact<br>Block and Base<br>Assembly ①                                    | 2 or 4<br>pole | 40410-493-03                   | 40410-493-04                   | 40420-494-02                   | 40430-462-53                   | 40440-462-53                   | 42450-802-01                 |
|      |   | 3 pole         | 40410-495-03                   | 40410-495-04                   | 40420-496-02                   | 40430-462-54                   | 40440-462-54                   | 42450-802-03                 |
| 3A   | Saddle Clamp Assembly   |                | X-225492                       |                                |                                | Does Not Apply                 |                                |                              |
| 3B   | Lug   | 2 pole         | Does Not Apply                 |                                | X-316012                       | X-316013                       | X-316014                       | 42450-020-01                 |
|      |   | 3-4 pole       |                                |                                | X-316012                       | X-316013                       | X-316160                       | 42450-804-01                 |
| 3C   | Bolt  |                | Does Not Apply                 |                                | M-6289                         | M-6532                         | M-6834                         | Included in 3D               |
| 3D   | Front Terminal without<br>Contact   |                | ②                              |                                |                                | 40430-022-02                   | 40440-030-02                   | 42450-302-52                 |
| 3E   | Rear Terminal without<br>Contact  |                |                                |                                |                                | 40430-024-02                   | 40440-314-51                   | 40440-314-51                 |
| 3F   | Front/Rear Terminal Screw   |                |                                |                                |                                | 28168-107-26                   | 28168-502-26                   | ③                            |
| 4    | Coil Cover  |                | 40410-496-01                   | 40420-497-01                   | 40430-454-51                   | 40440-454-51                   | 42450-803-01                   |                              |
| 6    | Auxiliary Contact Block<br>(1 N.O.)   |                | 595-A                          |                                |                                |                                |                                |                              |
| 6A   | Auxiliary Contact Block<br>(1 N.C.L.B.)   |                | 595-BL                         |                                |                                |                                |                                |                              |
| 7    | Operating Coil  |                | See table on page 3            |                                |                                |                                |                                |                              |
| 8    | Yoke (50-60 Hz)   |                | 40410-805-01                   | 40420-805-01                   | 40430-805-01                   | 40440-805-01                   |                                |                              |
| 9    | Movable Contact   |                | Order Single Pole Contact Set  |                                |                                |                                |                                |                              |
| 10   | Contact Spring  |                |                                |                                |                                |                                |                                |                              |
| 11   | Front Stationary Contact  |                |                                |                                |                                |                                |                                |                              |
| 12   | Rear Stationary Contact   |                |                                |                                |                                |                                |                                |                              |
| 9-12 | Single Pole Contact Set<br>(2 or 3 pole contactors)<br>(includes [1] each items 9-12) |                | 40410-331-53                   | 40410-331-54                   | 40420-322-52                   | 40430-300-52                   | 40440-325-52                   | 42450-805-02                 |
|      | Single Pole Contact Set<br>(4 pole contactors)<br>(includes [1] each items 9-12)      |                | 40410-331-53<br>(4 pole units) | 40410-331-54<br>(4 pole units) | 40420-322-52<br>(4 pole units) | 40430-300-53<br>(4 pole units) | 40440-325-53<br>(4 pole units) | Does Not<br>Apply            |
| -    | Power Pole Adder ④<br>(4 pole units only)   |                | 40410-452-04                   | 40410-452-08                   | 40420-452-04                   | 40430-453-51                   | 40440-452-51                   | Does Not<br>Apply            |
| 16   | Mounting Plate  |                | 40410-031-02                   |                                | 40420-014-02                   | 40430-044-02                   | 40440-027-02                   |                              |

① Less Contacts. Order one Single Pole Contact Set for each power pole.

② Front and rear terminal assembly not available as a renewal part. Replace the complete stationary contact block and base assembly.

③ Front Terminal Screw Part No. is 28168-503-26 and Rear Terminal Screw Part No. is 28168-502-6.

④ Contacts in Power Pole Adders (sizes 3-4) are replaceable. Order the single pole contact kit of the same starter size.

Renewal Parts  
 Bulletin 500LP, Sizes 0 through 4, Size 5 (series L)

Operating Coils and Modules – Sizes 0-3

Important:

Do not apply the AC voltage to the coil terminals of a permanent magnet type contactor.

To do so will partially de-magnetize the permanent magnet. Permanent Magnets are not available as a renewal part.

| Coil and Module Renewal Part Number |             |    |          |                  |        |                  |               |                  |
|-------------------------------------|-------------|----|----------|------------------|--------|------------------|---------------|------------------|
| Cat. No. Coil<br>Suffix Code        | AC<br>Volts | Hz | Size 0-1 |                  | Size 2 |                  | Size 3        |                  |
|                                     |             |    | Coil     | Module<br>Number | Coil   | Module<br>Number | Coil          | Module<br>Number |
| J                                   | 24          | 60 | LB013    | 40410-855-01     | LC013  | 40410-855-50     | Not Available |                  |
| D                                   | 110         | 60 | LB032    | 40410-855-02     | LC032  | 40410-855-51     | LD032         | 40410-856-01     |
| D                                   | 120         | 60 | LB036    | 40410-855-03     | LC036  | 40410-855-52     | LD036         | 40410-856-02     |
| S                                   | 110         | 50 | LB036    | 40410-855-03     | LC036  | 40410-855-52     | LD036         | 40410-856-02     |
| H                                   | 208         | 60 | LB049    | 40410-855-04     | LC049  | 40410-855-53     | LD049         | 40410-856-03     |
| A                                   | 220         | 60 | LB051    | 40410-855-05     | LC051  | 40410-855-54     | LD051         | 40410-856-04     |
| A                                   | 240         | 60 | LB054    | 40410-855-06     | LC054  | 40410-855-55     | LD054         | 40410-856-05     |
| P                                   | 220         | 50 | LB054    | 40410-855-06     | LC054  | 40410-855-55     | LD054         | 40410-856-05     |
| F                                   | 277         | 60 | LB060    | 40410-855-07     | LC060  | 40410-855-56     | LD060         | 40410-856-06     |
| B                                   | 440         | 60 | LB071    | 40410-855-10     | LC071  | 40410-855-59     | LD071         | 40410-856-09     |
| B                                   | 480         | 60 | LB073    | 40410-855-11     | LC073  | 40410-855-60     | LD073         | 40410-856-10     |
| Q                                   | 440         | 50 | LB073    | 40410-855-11     | LC073  | 40410-855-60     | LD073         | 40410-856-10     |
| C                                   | 550         | 60 | LB076    | 40410-855-12     | LC076  | 40410-855-61     | LD076         | 40410-856-11     |
| C                                   | 600         | 60 | LB078    | 40410-855-13     | LC078  | 40410-855-62     | LD078         | 40410-856-12     |
| R                                   | 550         | 50 | LB078    | 40410-855-13     | LC078  | 40410-855-62     | LD078         | 40410-856-12     |

Operating Coils and Modules – Sizes 4-5

| Coil and Module Renewal Part Number |             |    |               |                  |               |                  |
|-------------------------------------|-------------|----|---------------|------------------|---------------|------------------|
| Cat. No. Coil<br>Suffix Code        | AC<br>Volts | Hz | Size 4        |                  | Size 5        |                  |
|                                     |             |    | Coil          | Module<br>Number | Coil          | Module<br>Number |
| J                                   | 24          | 60 | Not Available |                  | Not Available |                  |
| D                                   | 110         | 60 | LE032         | 40410-856-51     | LE032         | 40410-856-51     |
| D                                   | 120         | 60 | LE036         | 40410-856-52     | LE036         | 40410-856-52     |
| S                                   | 110         | 50 | LE036         | 40410-856-52     | LE036         | 40410-856-52     |
| H                                   | 208         | 60 | LE049         | 40410-856-53     | LE049         | 40410-856-53     |
| A                                   | 220         | 60 | LE051         | 40410-856-54     | LE051         | 40410-856-54     |
| A                                   | 240         | 60 | LE054         | 40410-856-55     | LE054         | 40410-856-55     |
| P                                   | 220         | 50 | LE054         | 40410-856-55     | LE054         | 40410-856-55     |
| F                                   | 277         | 60 | LE060         | 40410-856-56     | LE060         | 40410-856-56     |
| B                                   | 440         | 60 | LE071         | 40410-856-59     | LE071         | 40410-856-59     |
| B                                   | 480         | 60 | LE073         | 40410-856-60     | LE073         | 40410-856-60     |
| Q                                   | 440         | 50 | LE073         | 40410-856-60     | LE073         | 40410-856-60     |
| C                                   | 550         | 60 | LE076         | 40410-856-61     | LE076         | 40410-856-61     |
| C                                   | 600         | 60 | LE078         | 40410-856-62     | LE078         | 40410-856-62     |
| R                                   | 550         | 50 | LE078         | 40410-856-62     | LE078         | 40410-856-62     |

## Important User Information

Because of the variety of uses for the products described in this publication, those responsible for the application and use of this control equipment must satisfy themselves that all necessary steps have been taken to assure that each application and use meets all performance and safety requirements, including any applicable laws, regulations, codes and standards.

The illustrations, charts, sample programs and layout examples shown in this guide are intended solely for purposes of example. Since there are many variables and requirements associated with any particular installation, Rockwell Automation does not assume responsibility or liability (to include intellectual property liability) for actual use based upon the examples shown in this publication.

Allen-Bradley publication SGI-1.1, *Safety Guidelines for the Application, Installation and Maintenance of Solid-State Control* (available from your local Allen-Bradley office), describes some important differences between solid-state equipment and electromechanical devices that should be taken into consideration when applying products such as those described in this publication.

Reproduction of the contents of this copyrighted publication, in whole or part, without written permission of Rockwell Automation, is prohibited.

Throughout this document we use notes to make you aware of safety considerations:

---

**ATTENTION**

Identifies information about practices or circumstances that can lead to personal injury or death, property damage or economic loss



---

**IMPORTANT**

Identifies information that is critical for successful application and understanding of the product.

---

Use only replacement parts and devices recommended by Rockwell Automation to maintain the integrity of the equipment. It is the user's responsibility to ensure that the renewal part number selected is properly matched to the model, series and revision level of the equipment being serviced.

---

**ATTENTION**

Servicing energized Industrial Control Equipment can be hazardous. Severe injury or death can result from electrical shock, burn, or unintended actuation of controlled equipment. Recommended practice is to disconnect and lockout control equipment from power sources, and release stored energy, if present.



---

Refer to **National Fire Protection Association Standard No. NFPA70E, Part 2 and (as applicable) OSHA rules for Control of Hazardous Energy Sources (Lockout/Tagout) and OSHA Electrical Safety Related Work Practices** for safety related work practices, including procedural requirements for lockout/tagout, and appropriate work practices, personnel qualifications and training requirements where it is not feasible to de-energize and lockout or tagout electric circuits and equipment before working on or near exposed circuit parts.

ROCKWELL DISCLAIMS ALL WARRANTIES WHETHER EXPRESSED OR IMPLIED IN RESPECT TO THE INFORMATION (INCLUDING SOFTWARE) PROVIDED HEREBY, INCLUDING THE IMPLIED WARRANTIES OF FITNESS FOR A PARTICULAR PURPOSE, MERCHANTABILITY, AND NON-INFRINGEMENT. Note that certain jurisdictions do not countenance the exclusion of implied warranties; thus, this disclaimer may not apply to you.

Allen-Bradley is a trademark of Rockwell Automation