

CRITICAL TO QUALITY CLASSIFICATION TABLE					
P=PERFORMANCE, F=FIT, A=ASSEMBLY					
X=IDENTIFIES APPLICABLE CLASSIFICATION(S)					
◇=ENGINEERING AND/OR MANUFACTURING REQUIREMENT					
Ⓜ=REGULATORY REQUIREMENT-CONFORMANCE IS MANDATORY					
COMMENTS	DRAWING ZONE	P	F	A	R
ROHS	G1-HI				X

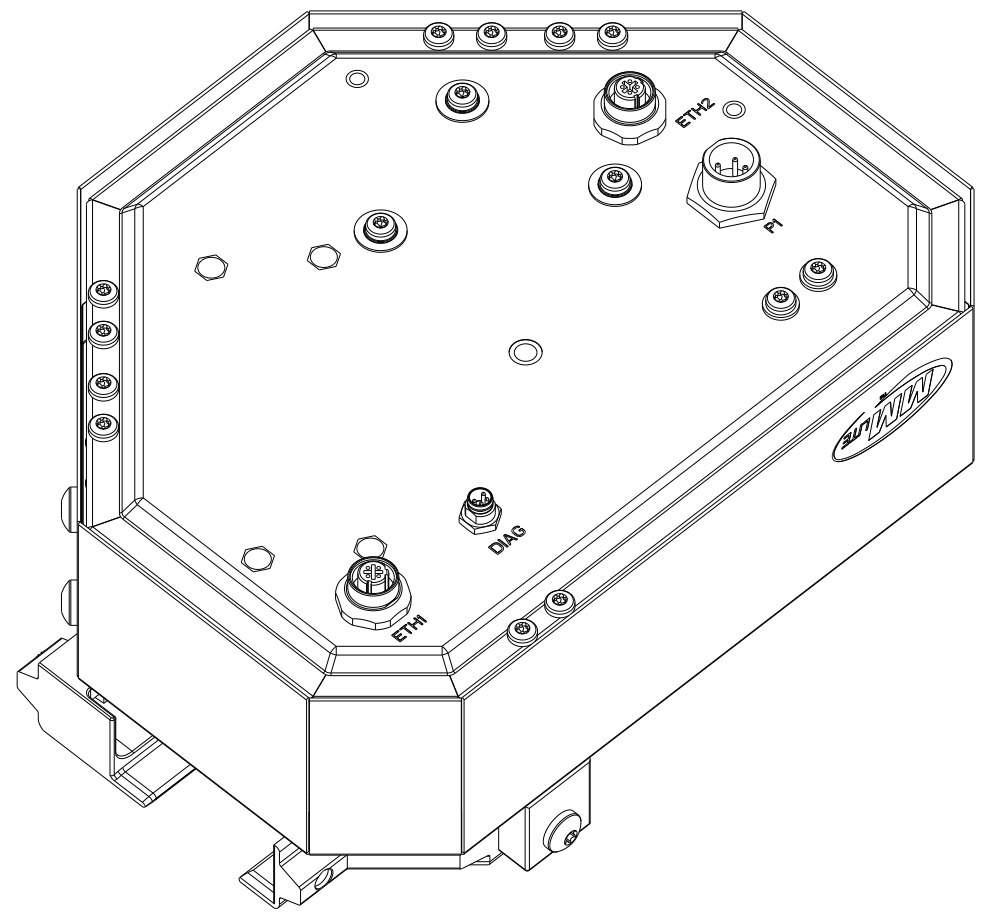
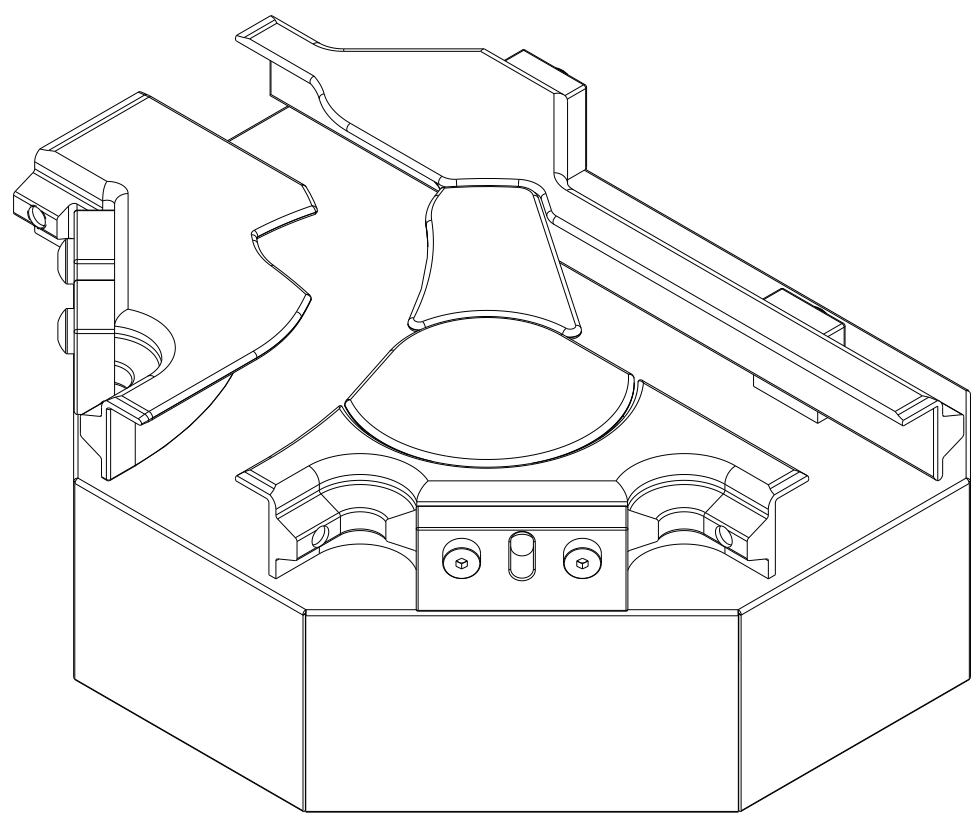

MUST COMPLY WITH ROCKWELL AUTOMATION ENVIRONMENTAL SPECIFICATION 970-20-01

- NOTES:
1. ALL DIMENSIONS ARE IN MM
 2. BREAK ALL SHARP EDGES
 3. CLEAN AND DEBURR
 4. USE MIN BEND RADII

A. CHOUACH	1:2	XXXXX-XXX-XX	1.6	SEE BOM	10004816210	PN-518264
ENGINEER	SCALE	WORKMANSHIP STANDARDS	FINISH	MATERIAL	MODEL/DIR NO.	PART/MMR NUMBER
DIMENSION UNITS-mm		ALL UNDIMENSIONED GEOMETRIES ARE CONTROLLED BY THE CAD MODEL. IN CASE OF DIMENSION DISCREPANCY, CAD MODEL OVERRIDES.		<h1>Rockwell Automation</h1>		CONFIDENTIAL AND PROPRIETARY INFORMATION. THIS DOCUMENT CONTAINS CONFIDENTIAL AND PROPRIETARY INFORMATION OF ROCKWELL AUTOMATION, INC. AND MAY NOT BE USED, COPIED OR DISCLOSED TO OTHERS, EXCEPT WITH THE AUTHORIZED WRITTEN PERMISSION OF ROCKWELL AUTOMATION, INC.
DIMENSIONS APPLY BEFORE SURFACE TREATMENT.		UNSPECIFIED TOLERANCES ARE AS FOLLOWS:				
		X.XX ±0.13 X.X ±0.25 X. ±0.5 DEG ±0.5° TORQUE ±25%		THIRD ANGLE PROJECTION 		DATE: 2019-05-20 SHEET 1 OF 3
		ICD, MOTOR, RT SW, AL RAIL, G4E-LF, ML		SIZE: B DIR: 10003964179	VER: 01	
				CREATED BY: APATEL11	CHANGED BY: *****	

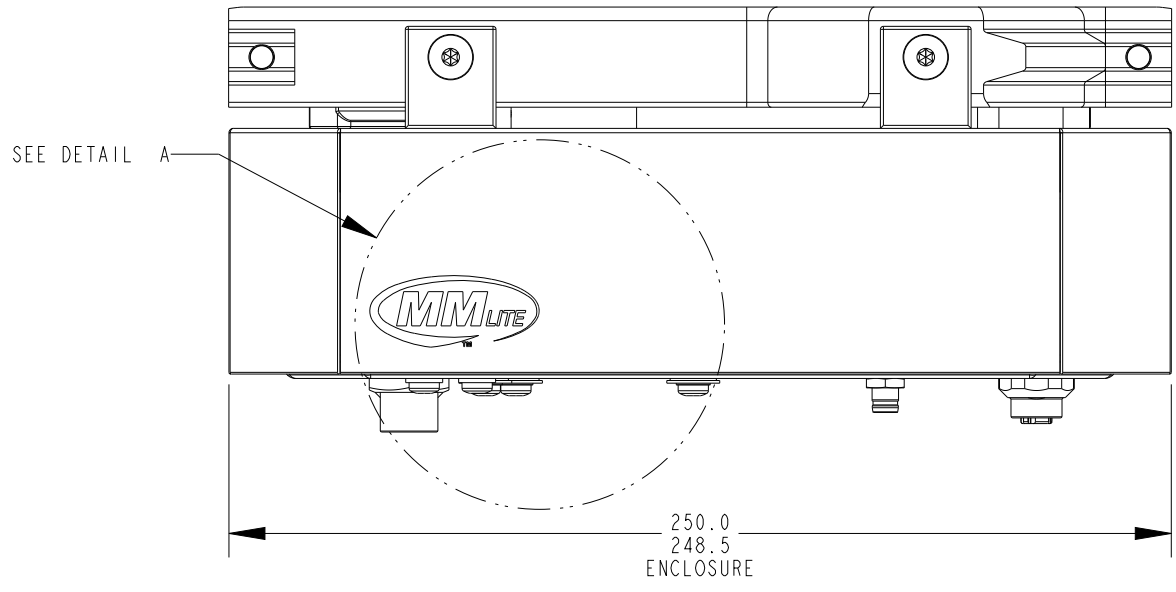
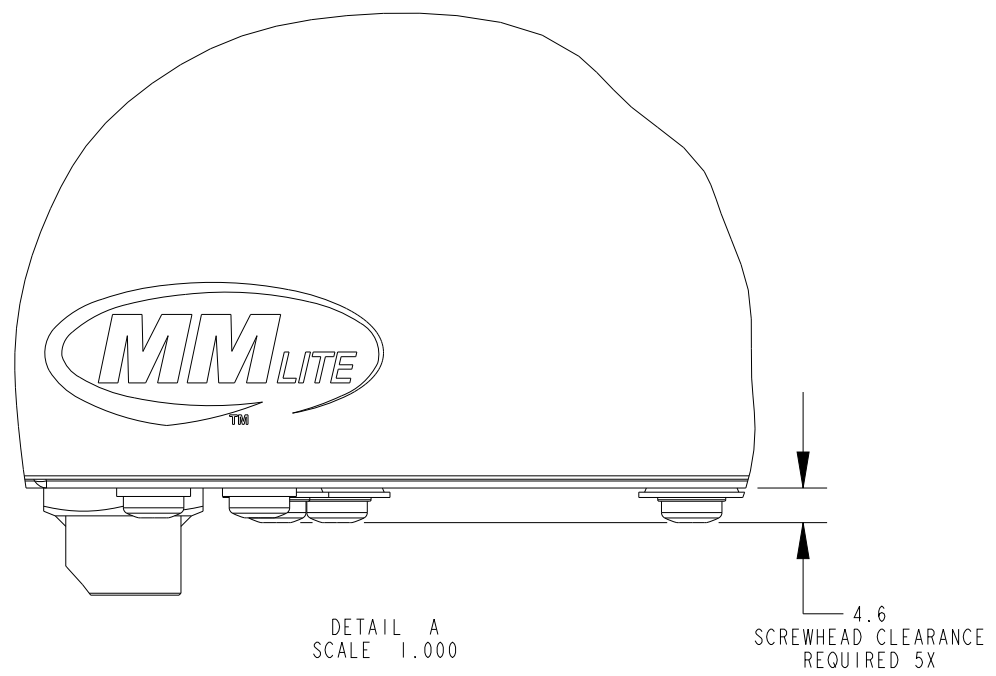
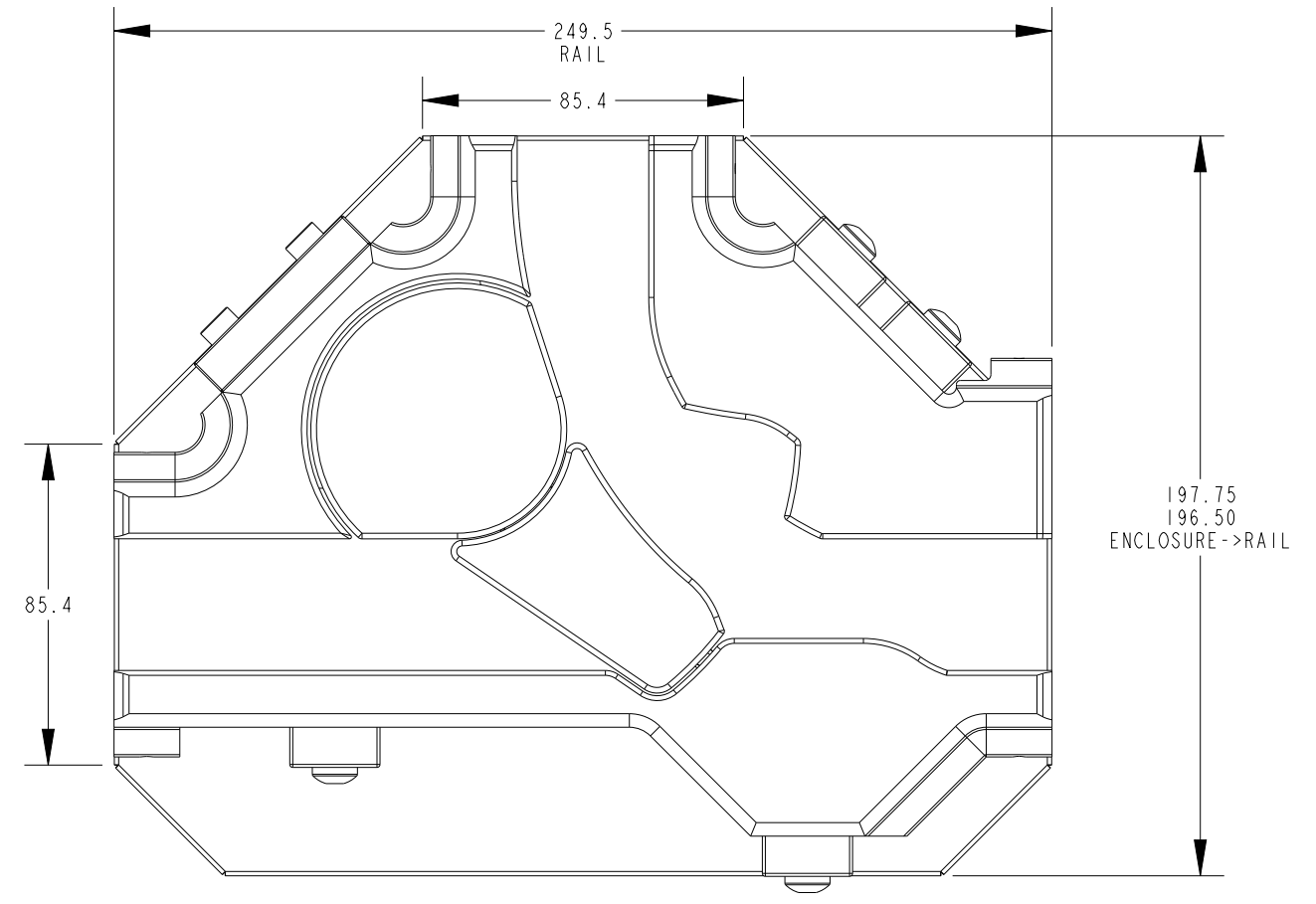
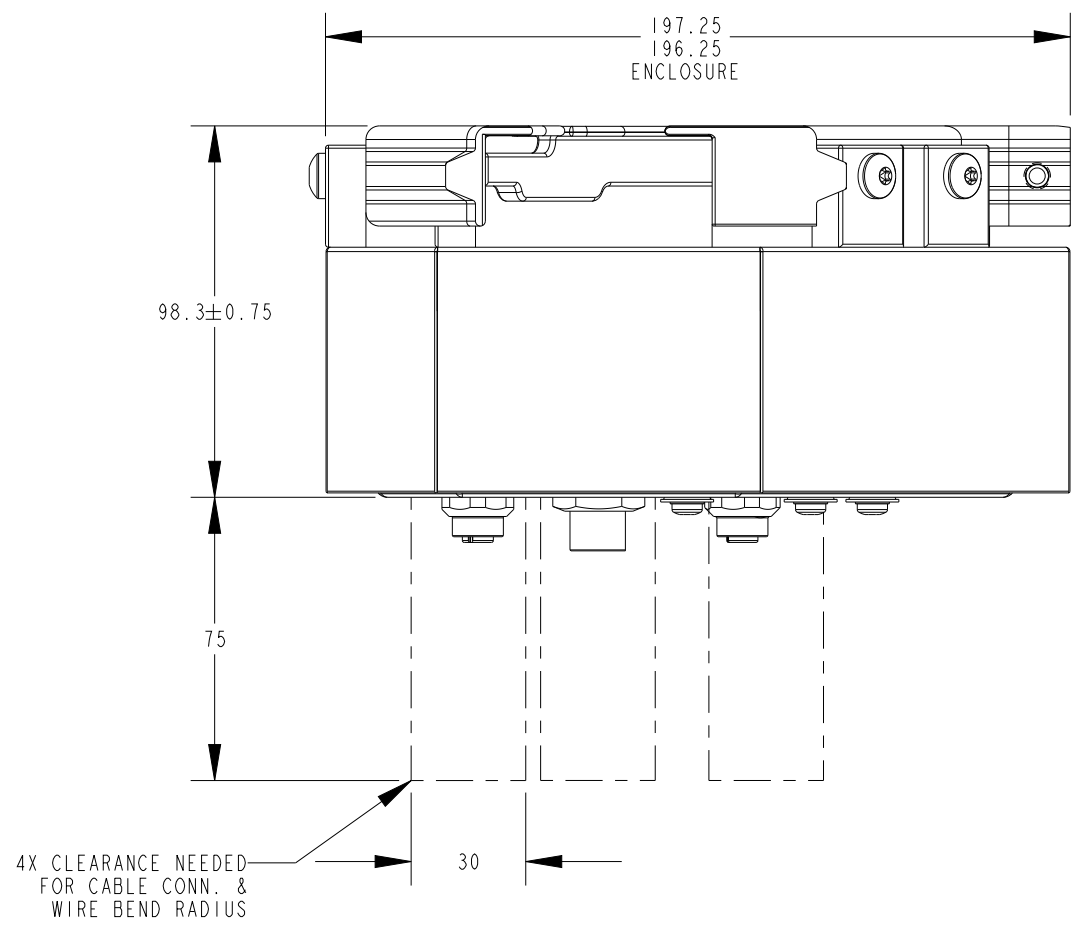

<p>Rockwell Automation</p>		<p>CONFIDENTIAL AND PROPRIETARY INFORMATION. THIS DOCUMENT CONTAINS CONFIDENTIAL AND PROPRIETARY INFORMATION OF ROCKWELL AUTOMATION, INC. AND MAY NOT BE USED, COPIED OR DISCLOSED TO OTHERS, EXCEPT WITH THE AUTHORIZED WRITTEN PERMISSION OF ROCKWELL AUTOMATION, INC.</p>			
		<p>DATE: 2019-05-20</p>	<p>SHEET 2 OF 3</p>		<p>VER</p>
<p>DESCRIPTION</p>	<p>ICD, MOTOR, RT SW, AL RAIL, G4E-LF, ML</p>		<p>SIZE</p>	<p>DIR</p>	<p>VER</p>
<p>CREATED BY: APATEL I I</p>	<p>CHANGED BY: *****</p>		<p>B</p>	<p>10003964179</p>	<p>01</p>

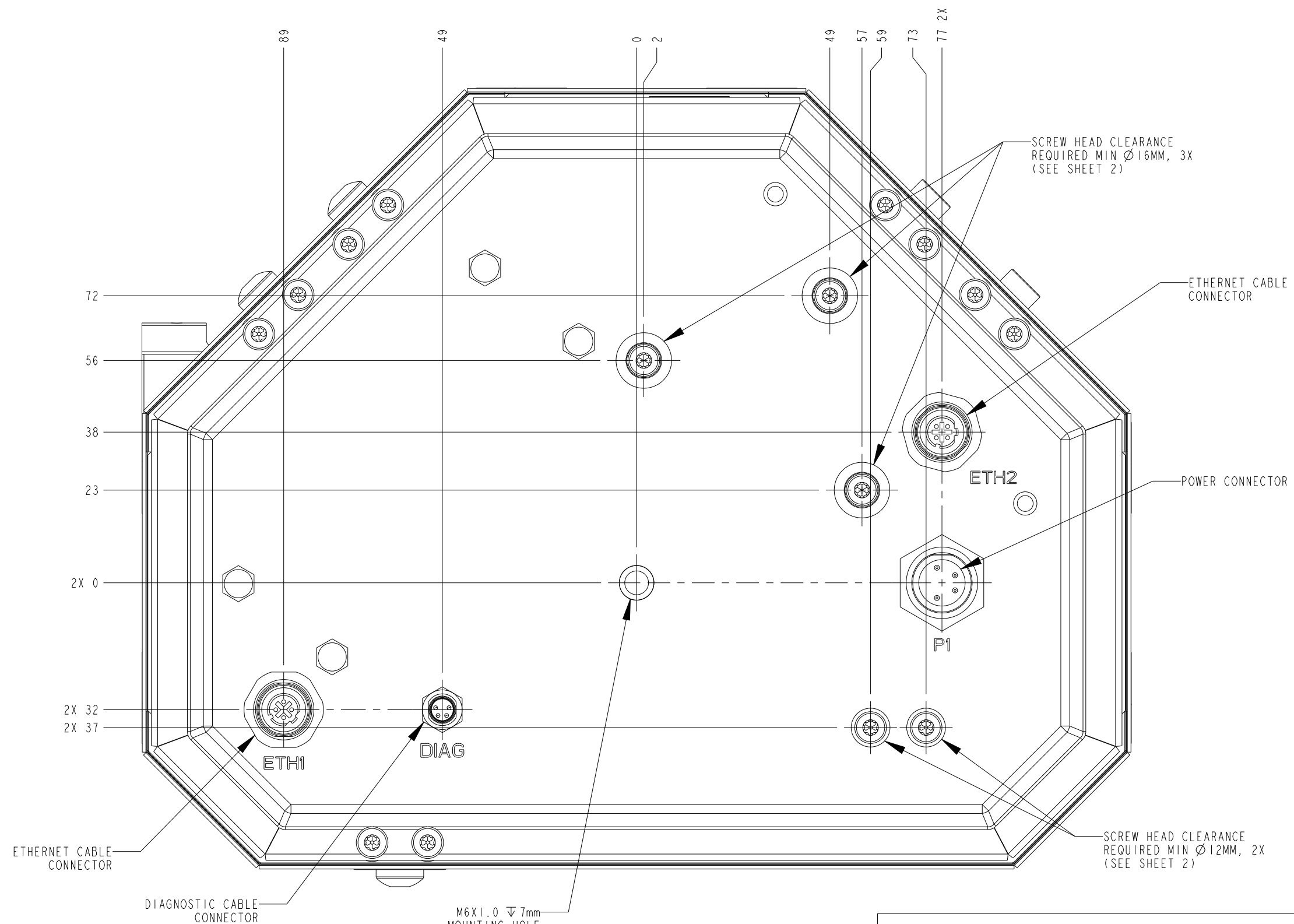

M6X1.0 ∇ 7mm
MOUNTING HOLE
MAX ALLOWABLE TORQUE = 5.5Nm

SCALE 0.900

<p>Rockwell Automation</p>		<p>CONFIDENTIAL AND PROPRIETARY INFORMATION. THIS DOCUMENT CONTAINS CONFIDENTIAL AND PROPRIETARY INFORMATION OF ROCKWELL AUTOMATION, INC. AND MAY NOT BE USED, COPIED OR DISCLOSED TO OTHERS, EXCEPT WITH THE AUTHORIZED WRITTEN PERMISSION OF ROCKWELL AUTOMATION, INC.</p>			
		DATE: 2019-05-20	SHEET 3 OF 3		
DESCRIPTION	ICD, MOTOR, RT SW, AL RAIL, G4E-LF, ML		SIZE	DIR	VER
	CREATED BY: APATEL I I	CHANGED BY: *****	B	10003964179	01