

CRITICAL TO QUALITY CLASSIFICATION TABLE					
P=PERFORMANCE, F=FIT, ASSEMBLY					
X=IDENTIFIES APPLICABLE CLASSIFICATION(S)					
◇=ENGINEERING AND/OR MANUFACTURING REQUIREMENT					
⊕=REGULATORY REQUIREMENT - CONFORMANCE IS MANDATORY					
COMMENTS	DRAWING (ZONE)	P	F	A	R
ROHS	H1				X

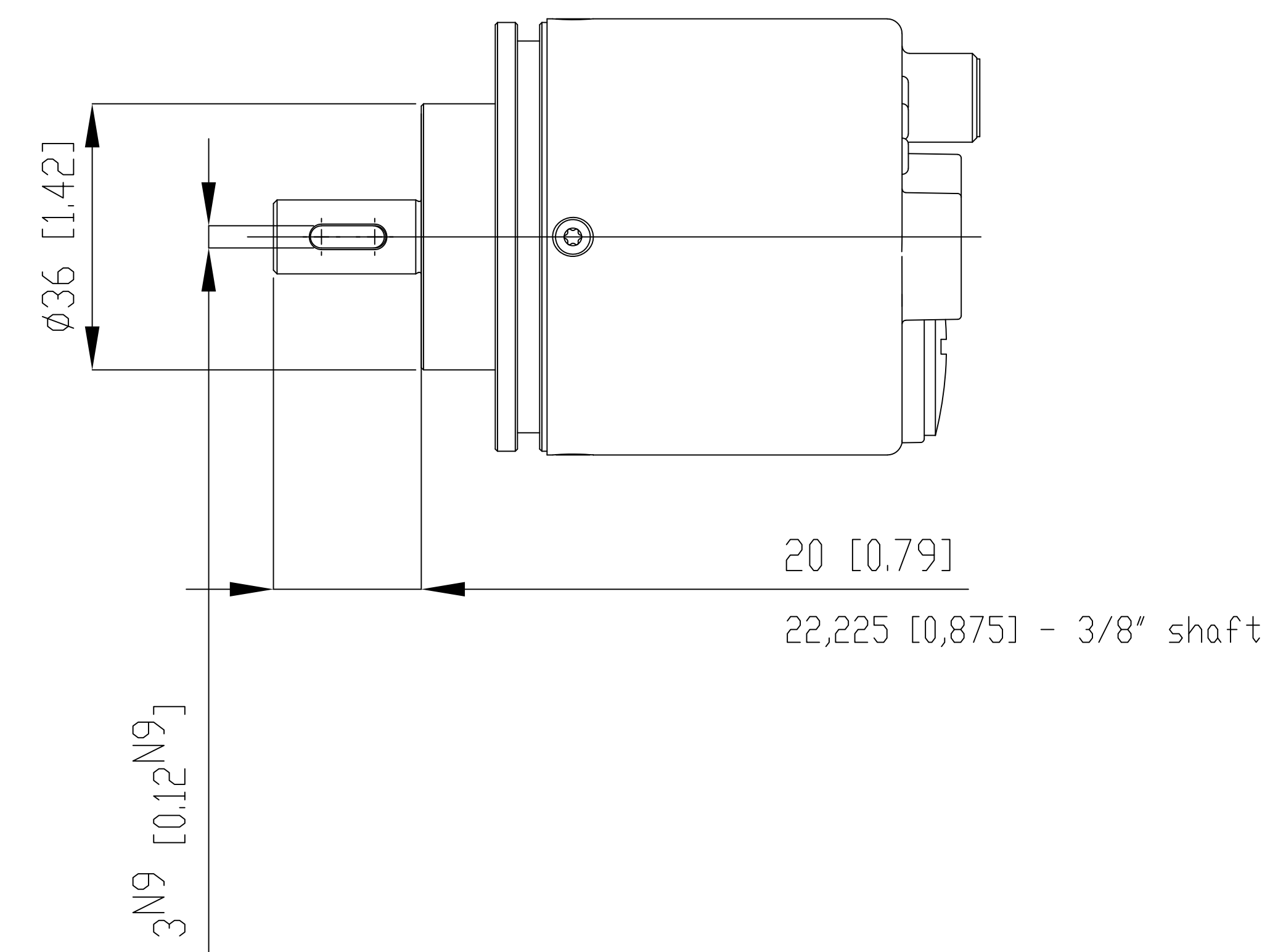
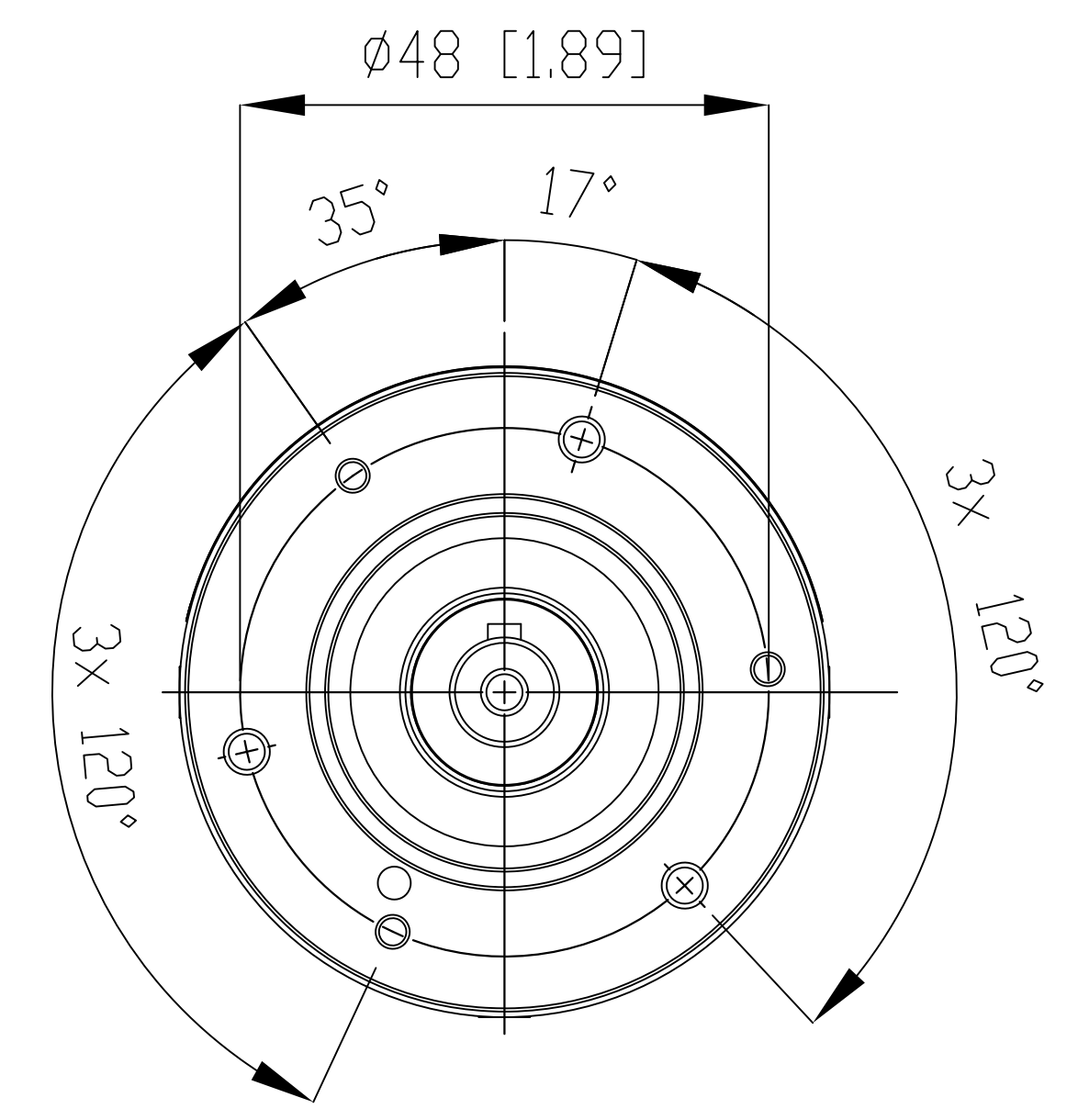
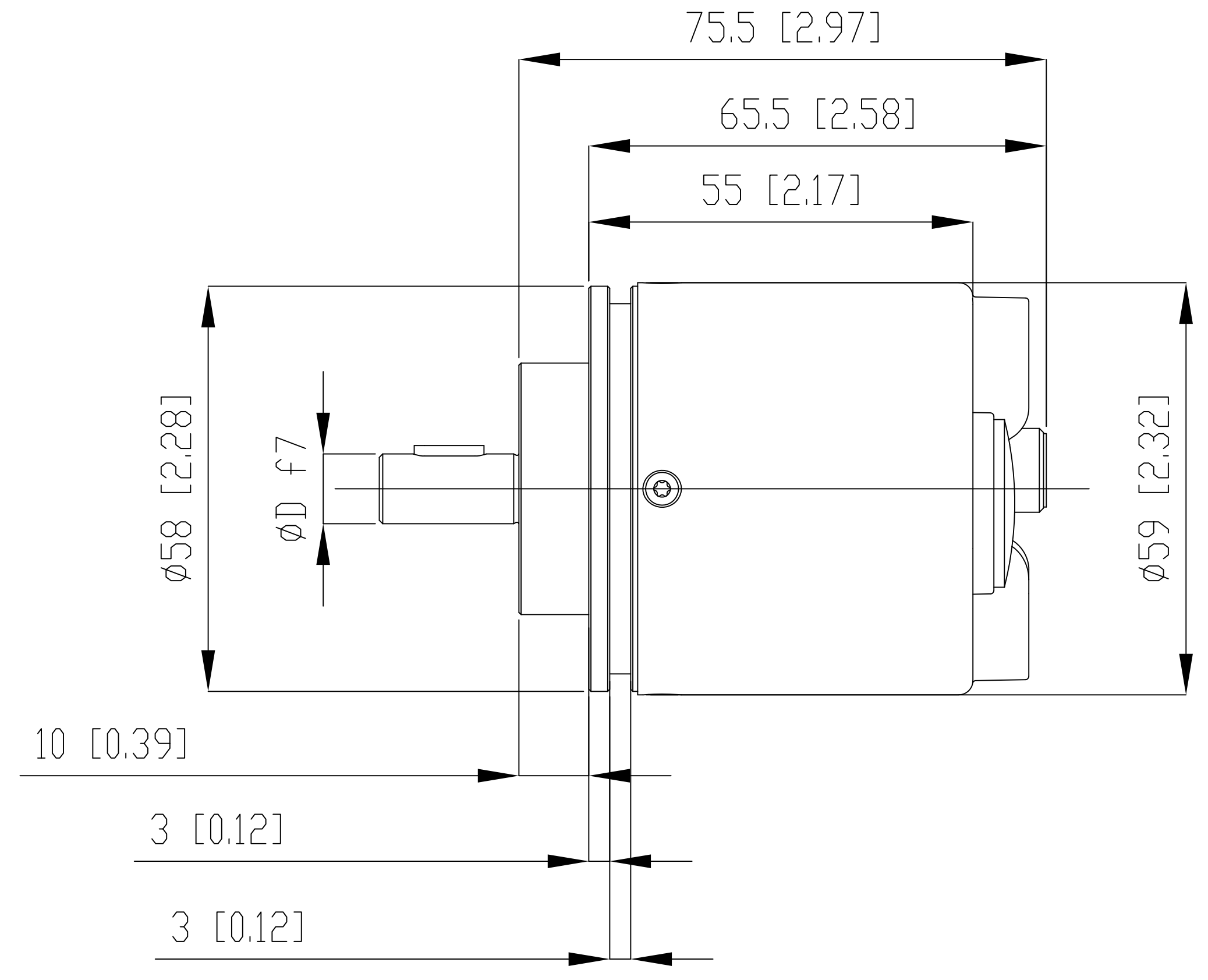
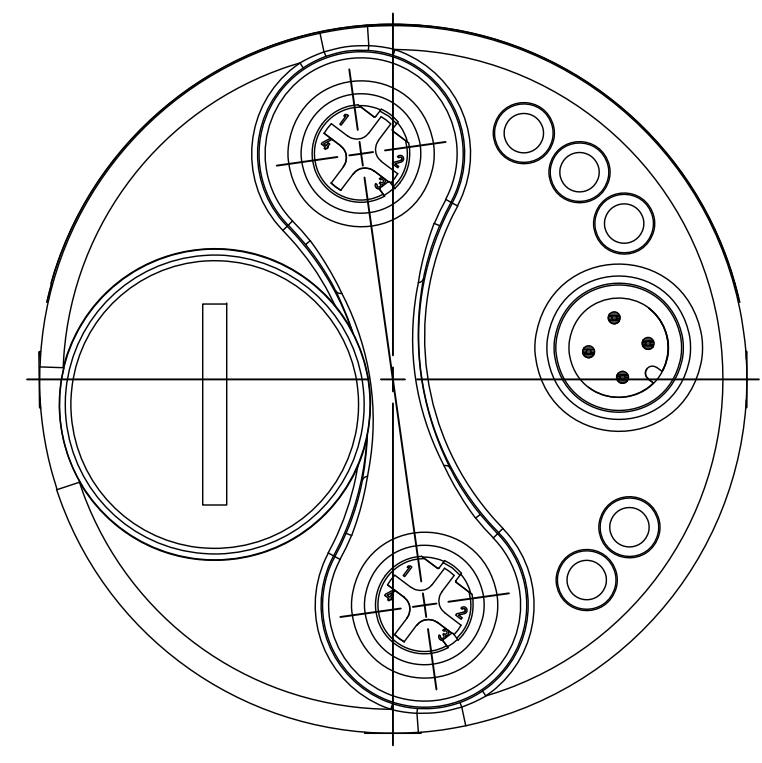

CLAMPING FLANGE

- NOTES:
1. ALL DIMENSIONS IN MM (INCHES) AND ARE FOR REFERENCE ONLY.
 2. 10 MM, 12 MM AND 3/8 INCH SHAFT DIAMETERS ØD.

		CONFIDENTIAL AND PROPRIETARY INFORMATION. THIS DOCUMENT CONTAINS CONFIDENTIAL AND PROPRIETARY INFORMATION OF ROCKWELL AUTOMATION, INC. AND MAY NOT BE USED, COPIED OR DISCLOSED TO OTHERS, EXCEPT WITH THE AUTHORIZED WRITTEN PERMISSION OF ROCKWELL AUTOMATION, INC.	
DESCRIPTION	DATE	SHEET	OF
843ES CIP SAFETY ETHERNET IP, ENCODER	2020-01-14	1	1
CREATED BY	CHANGED BY	DIR	VER
NKUMAR23	NKUMAR23	D	1
		843ES-XIPXA1	

MUST COMPLY WITH ROCKWELL AUTOMATION ENVIRONMENTAL SPECIFICATION 970-20-01