

Rockwell
Automation



Allen-Bradley

Product Information Packet

Rockwell Automation

CM227-BK01018AXZCA

10HP,1800RPM,3PH,60HZ,215TC,TENV

CM227-BK01018AXZCA

Motor Family

Torque Speed

Enclosure Code

Horsepower Load Type

Temp Rating Mount Type

Insulation Start Type

Duty Design Frame

Model # Y991

Voltage Usable at 208V

Base Speed Amps

CHP Speed Max Speed

Conduit Box Location Service Factor

Bearing Type: ODE Bearing

Grease DE Bearing

OPTIONS

Encoder PPR Tachometer Tach Voltage

Heater Blower Voltage

Holding Brake Ft. Lbs Coil Voltage Thermostats

Winding RTD'S Bearing RTD'S Ohms Type

Performance Data:

% of Rated Load	Efficiency	Power Factor	Amps
No Load			13 / 6.5
1/2 Load	89.5	60.5	
3/4 Load	91.0	72.0	
Full Load	91.0	78.0	26 / 13

Hazardous Location	
Division	
Class	
Group	
Temp Code	

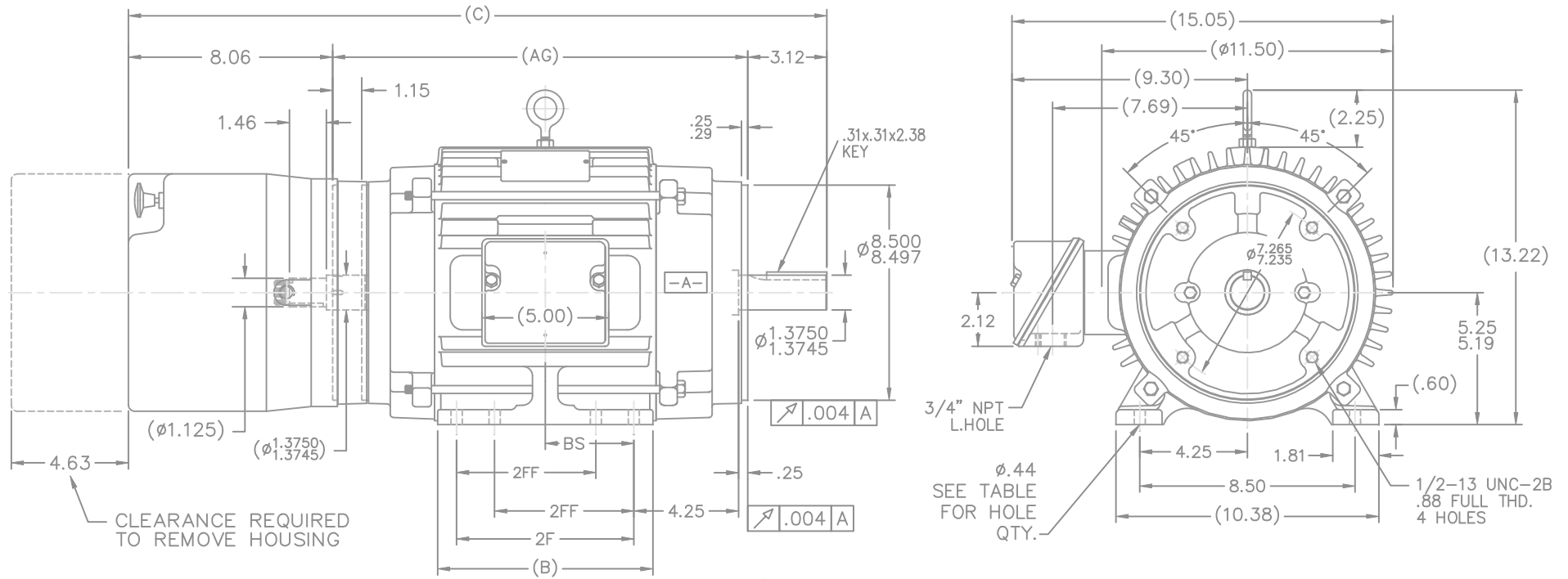

CLEARANCE REQUIRED TO REMOVE HOUSING

3/4" NPT L.HOLE
 2.12
 0.44
 SEE TABLE FOR HOLE QTY.

- NOTES:
1. CONDUIT BOX CAN BE ROTATED IN 90° STEPS.
 2. CONDUIT BOX CAN BE MOUNTED ON OPPOSITE SIDE BY
 3. NAMEPLATE TO BE READ FROM CONDUIT BOX

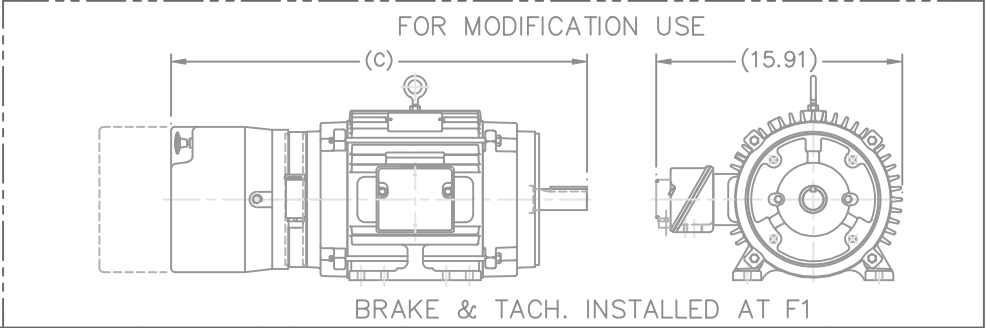

1000	213/5TC	28.83	17.65	9.75	8.25	7.00	4.75	8
DASH	FRAME	C	AG	B	2F	2FF	BS	FOOT HOLE QTY.

NO.		REVISION	BY & DATE	CHK	ANG	±	TOLERANCES UNLESS SPECIFIED	Rockwell Automation Allen-Bradley	DRAWN	DAH	06-18-2001	
8		UPDATED DRAWING	TJW 05/04/2007				DEC. INCHES		CHK	DRS	07-02-2001	
7		REVISED DASH 1000-FOOTHOLE CN29100-4873	RJW 10-24-2005	ML	.XX	±			APPD	CAV	07-02-2001	
6		REVISED DASH TABLE & FOOT HOLE QTY. CN33822	RJW 05-12-2005	ML	.XX	±			SCALE	1=4		
5		ADDED NOTE NUMBER 4 CN32977	RJW 02-08-2005	ML	.XXX	±		TITLE OUTLINE - TENV - LAKESHORE TACH.	REF			
4		ADD NOTE TO DETAIL & SEPARATE CN33633	RWR 10-07-2004	ML	.XXXX	±		210TC FR. - STEARNS 87,000 BRAKE	FMF			
3		-1000; 'B' DIM. WAS 8.50 NOW 9.75 CN 32026	DRS 01-14-2003	ML					PREV			
NO.		REVISION	BY & DATE	CHK	ANG	±						
		THIS DRAWING IN DESIGN AND DETAIL IS OUR PROPERTY AND MUST NOT BE USED EXCEPT IN CONNECTION WITH OUR WORK ALL RIGHTS OF DESIGN AND INVENTION ARE RESERVED THIS IS AN ELECTRONICALLY GENERATED DOCUMENT - DO NOT SCALE THIS PRINT						RFP	CAD FILE	ss88470	SIZE	DRAWING NO. PAGE 1 OF 1 REV.
								DIST	LB		B	SS88470 8

THREE PHASE
DUAL VOLTAGE MOTOR

HIGH VOLTAGE

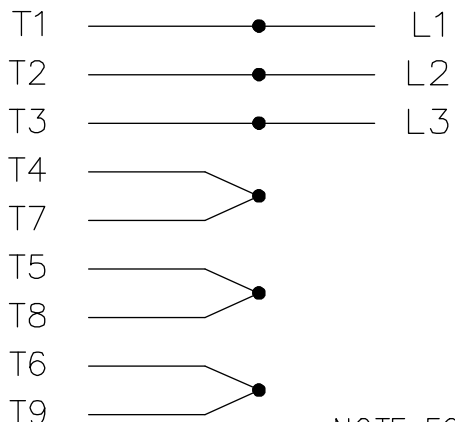

NOTE FOR FACTORY USE ONLY:
 TO SURGE TEST FOR COMMON CONNECT:
 HIGH VOLT: CONNECT P1 TO T1
 THEN P2 TO L1
 LOW VOLT: CONNECT P1 TO T1 & T7,
 THEN P2 TO L1

LOW VOLTAGE

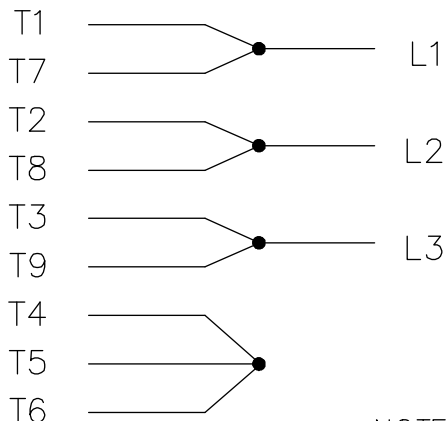

THERMO-PROTECTORS
CONNECTED IN SERIES.

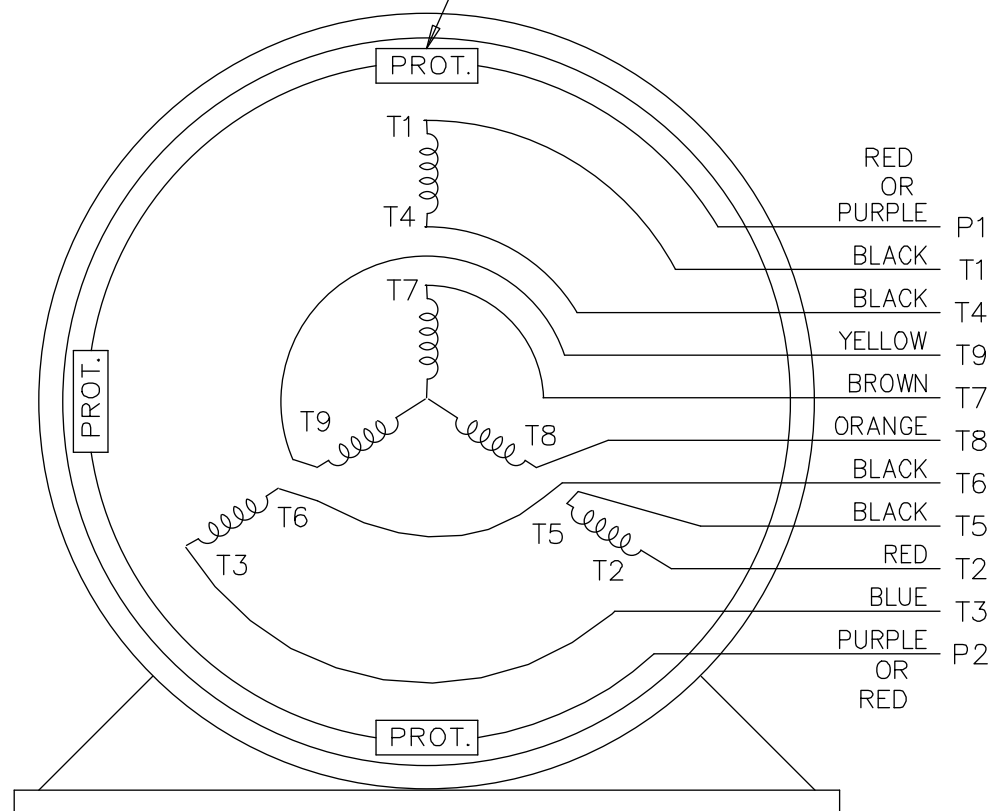

VIEW OF TERMINAL END

NOTE: LEAD'S COLOR CAN BE YELLOW OR WHITE FOR MT2 PLANT

13	NOTE ADDED	GR 06/20/13	AK	TOLERANCES UNLESS SPECIFIED			DRAWN SMC 05-13-1992			
12	P1 & P2 LEADS ADD'T COLOUR ADDED	UD 12/19/12	SR	DEC.	INCHES		CHK ML 05-13-1992			
11	ADDED COLORS TO "T & P" LEADS CN 40494	MSG 08-08-2006	ML	.X	±.1		APPD TB 05-13-1992			
10	ADDED SURGE TESTER NOTE - FOR FACTORY USE ONLY			.XX	±.02		SCALE 1=1			
		CN 24255	MH 06-03-1997		.XXX	±.005	REF			
9	REDRAWN	SMC 05-15-1992		.XXXX	±.0005	MAT'L.	FMF			
NO.	REVISION	BY & DATE	CHK	ANG	±7'30"	FINISH	PREV			
THIS DRAWING IN DESIGN AND DETAIL IS OUR PROPERTY AND MUST NOT BE USED EXCEPT IN CONNECTION WITH OUR WORK ALL RIGHTS OF DESIGN AND INVENTION ARE RESERVED THIS IS AN ELECTRONICALLY GENERATED DOCUMENT - DO NOT SCALE THIS PRINT			RFP	CAD FILE EE7308T			SIZE A	DRAWING NO. EE7308T	PAGE OF	REV. 13