

SPECIFICATIONS:

1. MOTOR INFORMATION

MOTOR TYPE: VARIABLE SPEED AC
 FRAME SIZE: RDL1307Y
 RATING: 29.8 KW
 VOLTAGE: 460
 ENCLOSURE: TOTALLY ENCLOSED IP54
 MOUNTING: FLANGE (300mm BOLT CIRCLE)
 COOLING: BLOWER COOLED IC416
 DRIVE METHOD: COUPLED OR BELTED
 ACCESSORIES: ENCODER

2. CONTINUOUS STALL TORQUE: 96 Nm
 MAX AT 155°C WINDING TEMPERATURE, IN A 40°C AMBIENT

3. OPERATING SPEED: 3000 BASE SPEED / 5000 RPM MAX.

4. 1024 SINUSOID/REV ENCODER, WITH MULTI-TURN ABSOLUTE POSITION DATA

5. FOR ADDITIONAL SPECIFICATIONS SEE L13M5175ESE

6. SHAFT HEIGHT WILL NOT BE EXCEEDED
 SHIMS UP TO 0.5 MM IN THICKNESS USUALLY REQUIRED FOR COUPLED OR GEARED MACHINES.

7. SHAFT EXTENSIONS ARE ACCORDING TO DIN 748, TOLERANCES ARE BASED ON THE ISA FITTING SYSTEM USING k6 FOR DIAMETERS UP TO 50MM AND m6 FOR DIAMETERS ABOVE.

8. MAX SHAFT TIR .06 [.002]
 MAX FACE TIR .13 [.005]

9. MOTOR WEIGHT 135 KG. [297 LBS] (MAY VARY 15%)

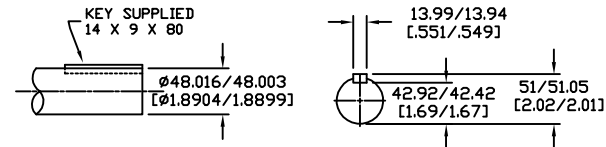

DRIVE END SHAFT DETAIL SPEC (9)

BLOWER CONNECTION	
STAR CONNECTION	
LEAD	460 VOLTS
U1	R
V1	S
W1	T
U2	
V2	
W2	
GRN/YEL	GROUND
DELTA CONNECTION	
LEAD	230 VOLTS
U1	
W2	R
V1	S
U2	
W1	T
V2	
GRN/YEL	GROUND

PIN-OUT	
ENCODER CONNECTOR	
PIN	FUNCTION
A	SIN +
B	SIN -
C	CDS +
D	CDS -
E	DATA +
F	DATA -
G-M	-
N	+9 VDC
P	COM
R	TS +
S	TS -
T-V	-

MOTOR CONNECTION	
TERMINAL BOX	
LEAD	SOURCE
U1	L1
V1	L2
W1	L3
GREEN	GROUND

NOTE: ALL DRAWING MODIFICATIONS REQUIRE CUSTOMER APPROVAL

REV	C/R	REVISION DESCRIPTION	DATE	BY
UNLESS OTHERWISE SPECIFIED		DRAWN BY	DATE	APPROVED BY
DO NOT SCALE DRAWING		GWS	3/03/06	WEM
DIMENSIONS ARE IN MILLIMETERS		CATALOG NO.		
WITH INCHES REFERENCED (X.X)		HPK-B1307E-MA42AA-ESM		
UNTOLERANCED DIMENSIONS ARE REFERENCE		PART NO.		
THIRD ANGLE PROJECTION		L13M5175		
Allen-Bradley		SCALE	DWG SIZE	SHEET
A/B		N/A	C	1 OF 1

DXF FILE AVAILABLE

