

SPECIFICATIONS:

1. MOTOR INFECTION
MOTOR TYPE: VARIABLE SPEED AC

FRAME SIZE: RDL1609Y
RATING: 48.4 KW
VOLTAGE: 460

ENCLOSURE: TOTALLY ENCLOSED IP54
MOUNTING: FLANGE (350mm BOLT CIRCLE)
COOLING: BLOWER COOLED IC416

DRIVE METHOD: COUPLED OR BELTED
ACCESSORIES: ENCODER & BRAKE

2. CONTINUOUS STALL TORQUE: 156 Nm
MAX AT 155°C WINDING TEMPERATURE, IN A 40°C AMBIENT

3. OPERATING SPEED: 3000 BASE SPEED / 5000 RPM MAX.

4. 1024 SINUSOID/REV ENCODER, WITH MULTI-TURN ABSOLUTE POSITION DATA

5. FOR ADDITIONAL SPECIFICATIONS SEE L16M5197ESE

6. SHAFT HEIGHT WILL NOT BE EXCEEDED SHIMS UP TO 0.5 MM IN THICKNESS USUALLY REQUIRED FOR COUPLED OR GEARED MACHINES.

7. SHAFT EXTENSIONS ARE ACCORDING TO DIN 748. TOLERANCES ARE BASED ON THE ISA FITTING SYSTEM USING K6 FOR DIAMETERS UP TO 50MM AND m6 FOR DIAMETERS ABOVE.

8. MAX SHAFT TIR .06 L0021
MAX FACE TIR .13 L0051

9. MOTOR WEIGHT 240 KG. (530 LBS) (MAY VARY 15%)

10. BRAKE RELEASES WHEN VOLTAGE APPLIED

BLOWER CONNECTION	
LEAD	460 VOLTS
11	L1
12	L2
13	L3
14	L3
15	L3
16	L3
17	L3
18	L3
19	L3

PIN-OUT ENCODER CONNECTOR	
LEAD	FUNCTION
A	SIN +
B	SIN -
C	COS +
D	COS -
E	DATA +
F	DATA -
G-H	-
N	+9 VDC
P	COM
R	TS +
S	TS -
T-V	-

MOTOR CONNECTION	
LEAD	TERMINAL BOX
U1	L1
V1	L2
W1	L3
	GREEN GROUND

BRAKE CONNECTION	
LEAD	460 V 1 PHASE SOURCE
B1	L1
B2	L2

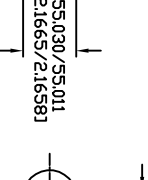
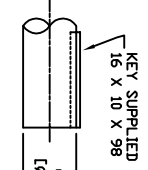

NOTE: ALL DRAWING MODIFICATIONS REQUIRE CUSTOMER APPROVAL

REV	C/R	REVISION DESCRIPTION	DATE	BY
		UNLESS OTHERWISE SPECIFIED		
		DO NOT SCALE DRAWING		
		DIMENSIONS ARE IN MILLIMETERS		
		WITH DIMENSIONS REFERENCED TO DDD		
		UNTOLERANCED DIMENSIONS ARE REFERENCE		
		THIRD ANGLE PROJECTION		

DXF FILE AVAILABLE

Allen-Bradley

SCALE: 1/16" = 1"

DATE: 3/06/06

APPROVED BY: WEM

DATE: 3/06/06

CATALOG NO. HPK-B1609E-MB44AA-ESM

PART NO. L16M5197

SHEET 1 OF 1