

MODEL	LB	LD	LE
MPL-x640	312,7 [12.31]	272,5 [10.73]	201,4 [7.93]
MPL-x660	363,5 [14.31]	323,3 [12.73]	252,2 [9.93]
MPL-x680	414,3 [16.31]	374,1 [14.73]	303 [11.93]
MPM-x2152	363,5 [14.31]	323,3 [12.73]	252,2 [9.93]
MPM-x2153	414,3 [16.31]	374,1 [14.73]	303 [11.93]
MPM-x2154	465,1 [18.31]	424,9 [16.73]	353,8 [13.93]

PIN-OUT		ENCODER CONNECTOR	
PIN	FUNCTION	PIN	FUNCTION
1	SIN +	1	SIN +
2	SIN -	2	SIN -
3	COS +	3	COS +
4	COS -	4	COS -
5	DATA +	5	DATA +
6	DATA -	6	DATA -
7-8	-	7-8	-
9-10	-	9-10	-
11	EPWR 9V	11	EPWR 9V
12	ECOM	12	ECOM
13	TS +	13	TS +
14	TS -	14	TS -
15-17	-	15-17	-

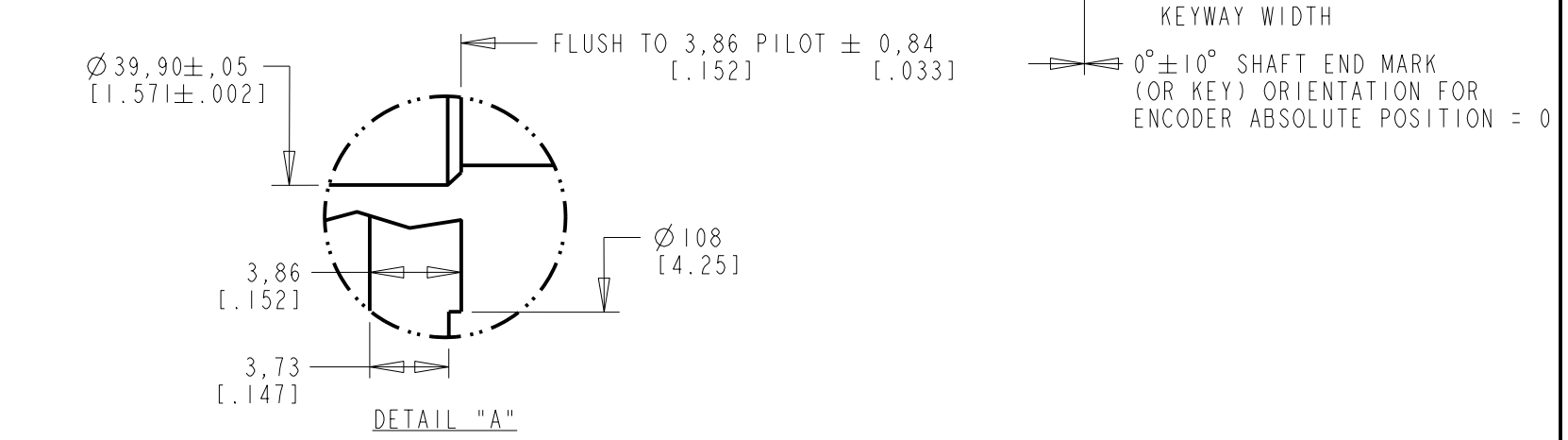

NOTE:

- DXF FILE OF THIS DRAWING MUST BE SCALED TO LENGTH, SEE CHART ABOVE. MODEL SHOWN IS MPL-x680x-xJ74AA.
- 3D STEP (.stp) FILES AVAILABLE AT ALL LENGTHS.
- THIS DRAWING COVERS SINGLE AND MULTI-TURN ABSOLUTE ENCODER MODELS (i.e. MPx-xxxxx-MJ74AA and MPx-xxxxx-SJ74AA)

REFERENCES		DESCRIPTION	CAD DOCUMENT	
VERSION	UNLESS OTHERWISE SPECIFIED	ESM, MPL-x6xxx-xJ74AA; MPM-x215xx-xJ74AA	Allen-Bradley 	
01	DO NOT SCALE DRAWING DIMENSIONS ARE IN MILLIMETERS WITH INCHES REFERENCED [X] UNTOLERANCED DIMENSIONS ARE REFERENCE 3RD ANGLE PROJECTION			
		DR. EQ	DATE 2-25-09	SHEET 1 OF 1
		DXF 2D OR STEP 3D FILE AVAILABLE		DWG. SIZE B
				DOCUMENT NUMBER 10000048336