

PIN-OUT		
ENCODER CONNECTOR		
PIN	FUNCTION	COLOR
1-6	-	-
7	EPWR	RED
8	ECOM + BAT-	BROWN/BLACK + BLACK
9	SHIELD	BLACK SHRINK
10-11	-	-
12	SD+	BLUE
13	SD-	BLUE/BLACK
14	BAT+	BROWN
15	-	-

PIN-OUT		
POWER CONNECTOR		
PIN	FUNCTION	COLOR
1	U	RED
2	V	WHITE
3	W	BLACK
4	GROUND	YELLOW/GREEN

PIN-OUT		
BRAKE CONNECTOR		
PIN	FUNCTION	COLOR
1	BR+	YELLOW
2	BR-	BLUE

SPECIFICATIONS:

- MOTOR TYPE: 8 POLE, 3 PHASE, WYE WINDING, PERMANENT MAGNET ROTOR, TOTALLY ENCLOSED, NON VENTILATED.
- CONTINUOUS STALL TORQUE: 1.16 Nm (10.3 LB-IN) MAX AT 125°C WINDING TEMPERATURE, IN A 40°C AMBIENT, WHEN MOUNTED ON AN 10 INCH SQUARE X 1/4 INCH THICK ALUMINUM HEAT SINK.
- OPERATING SPEED: 5000 RPM MAX.
- Ke: 32 ±10% V/KRPM 0-PEAK (PHASE TO PHASE) AT 20-30°C.
- SERIAL ENCODER, WITH 16 BIT MULTI-TURN AND 17 BIT SINGLE TURN ABSOLUTE POSITION DATA.
- BRAKE: 24VDC, 1.24 Nm (11 LB-IN) MAX HOLDING TORQUE. BRAKE RELEASES WHEN VOLTAGE APPLIED, EITHER POLARITY.
- FOR ADDITIONAL SPECIFICATIONS SEE TLA230PBJ34AAESE.

POWER CONNECTOR
AMP 350779-1 HOUSING
AMP 350218-3 PIN CONTACTS (U,V,W)
AMP 350654-1 PIN CONTACT (GROUND)

BRAKE CONNECTOR
AMP 172165-1
AMP 170359-1 PIN CONTACTS

ENCODER CONNECTOR
AMP 172171-1
AMP 770835-1 PIN CONTACTS

01	1007016	SJ	RELEASED	—	—
REV	ECN	BY	REVISION DESCRIPTION	DATE	CHKR
UNLESS OTHERWISE SPECIFIED			DRAWN BY	DATE	DESIGN ENGR
DO NOT SCALE DRAWING			SJ	3-09-04	—
DIMENSIONS ARE IN MILLIMETERS			TL-A230P-BJ34AA,ESM		
WITH INCHES REFERENCED [X.X]					
UNTOLERANCED DIMENSIONS ARE REFERENCE					
THIRD ANGLE PROJECTION					

ProE Version 0 Modified 0

DXF FILE AVAILABLE

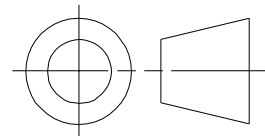

PART NO.
TLA230PBJ34AAESM

SCALE : 1
0.500

DWG SIZE
B

SHEET
1 OF 1